



# **FISCHER**

*die fahrradmarke*

EN

## **SYSTEM MANUAL**

**ORIGINAL OPERATING INSTRUCTIONS PEDELEC 2025 | ELECTRIC DRIVE**

# Contents

<b>Legal disclosure</b>	2	Inserting the battery	15
<b>General information</b>	3	LED charging state display	16
		Switching the electrical system on and off	16
<b>For your safety</b>	3	<b>Displays and settings</b>	17
<b>Pedelec tuning is prohibited</b>	3	LED 350 control unit and 550 control unit	17
<b>Safety Instructions</b>	4	LCD 850 and LCD 1350	18
<b>Intended use</b>	4	LCD 1050	21
<b>Maintenance and upkeep</b>	4	Brose Display Allround	29
		Ananda D18 Display	34
<b>Riding a pedelec</b>	5	Ananda D16 Display	39
How your pedelec works:	5	<b>FISCHER® e-Connect</b>	45
Your pedelec's range	5	Functional overview	45
<b>Before the first ride</b>	6	Download	46
<b>Before each ride</b>	6	<b>Transporting the pedelec</b>	46
<b>Electrical system</b>	6	<b>Replacing parts on your pedelec</b>	46
Important Instructions	6	<b>Environment protection tips/Disposal</b>	48
Operating display and display Screen	7	<b>Technical characteristics</b>	49
Battery	7	Battery	49
Charger	9	Charger	49
Drive unit	10	Motors	49
<b>Operation</b>	10	<b>Warranty</b>	50
Battery Pack in carrier rack	10	<b>Guarantees</b>	50
Frame battery	12	<b>Services</b>	51
Integrated battery	13	<b>After Sales Service</b>	52
Charging the battery	14		

# Legal disclosure

Fischer System version 5.0 April 2025

MTS Group, Inter-Union Technohandel GmbH,  
Carl-Benz-Strasse 2, 76761 Rülzheim, Tel:  
+49 7272 9801-100, Fax: +49 7272 9801-  
123, [www.mts-gruppe.com](http://www.mts-gruppe.com)  
MTS Group Inter-Union Technohandel  
GmbH is represented by: Managing director:  
Daniel Lück, Ralf Reuwer and Frank Jansen.

The declaration of conformity for Fischer  
pedelecs can be found on the internet at  
[www.fischer-fahrrad.de](http://www.fischer-fahrrad.de).

Responsible for distributing and marketing  
the operating instructions: inMotion mar.com  
[info@inmotionmar.com](mailto:info@inmotionmar.com), [www.inmotionmar.com](http://www.inmotionmar.com)

Contents and illustrations: Veidt-Anleitungen  
[info@veidt-anleitungen.de](mailto:info@veidt-anleitungen.de)

These operating instructions cover the  
requirements and scope of application of EU  
law. If this product is delivered or used outside  
the aforementioned area, the bicycle manu-  
facturer must provide the necessary operating  
instructions. Subject to modifications. Last  
updated at publication 04/2025

© Before reproducing, reprinting, translating  
or using this document for any commercial  
purpose (even in part, printed or electronic  
form), you must first receive written consent.

If you have any questions about your pedelec, please contact our service hotline for Germany (+49 721 97902560),  
for Austria (+43 1 9073366), for Poland (+48 22 738 64 60), for Croatia/Denmark (+800 3279 7834) or for the  
Czech Republic (+800 01 01 01).

## General information



When using this product, be sure to follow the instructions given in the original instruction manual.



Please ensure you read the chapters "Before the first ride" and "Before each ride" before using the pedelec for the first time.

- If you lend your pedelec to a third party, please give them all operating instructions along with the pedelec.
- Save these operating instructions on your computer/smartphone and keep them in a safe place for future reference.

You will also find a wide range of information and videos about use, maintenance and settings of your pedelec online.



<https://service.fischer-bike.com/downloads>

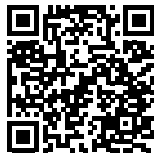

[www.youtube.com/user/FischerFahrradmarke](http://www.youtube.com/user/FischerFahrradmarke)

## For your safety



Always apply the pedelec's brakes before placing your foot on the pedal. The motor will drive forward as soon as you push down the pedal. This force may be unfamiliar and can lead to falls, danger or even traffic accidents, which could result in injury.

- Staring at the display screen for too long while cycling may result in you falling off or causing an accident.
- When riding a pedelec, make sure that you are fully familiar with the starting characteristics of the pedelec before riding it. If the pedelec starts off suddenly, accidents may occur.
- Neither the bike nor the drive may be tampered with to increase the speed or performance of the pedelec. Even the application of tuning kits or modifying the gear transmission is not permitted.

## Pedelec tuning is prohibited



Do not modify the pedelec's technology in any way. Manipulating the bike in any way to increase performance or speed can lead to legal problems and/or make the bike less safe to ride.

Possible legal implications:

- The pedelec is required by law to be registered for approval and insured. All legal requirements regarding the bike's configuration and as stated by the road traffic licensing authority must be adhered to.
- The manufacturer does not offer any kind of guarantee, warranty or liability.
- Criminal consequences cannot be ruled out. For instance, a negligent bodily injury may result in a legal offence.
- Expiry of the pedelec insurance

Possible technological implications:

- Tampering with the bike's technology may limit its capabilities, cause defects or break the bike parts.
- The motor and battery may become overloaded and overheat.  
Consequences: Irreparable damages and risk of fire
- The brakes and other parts may become overworked.  
Consequences: Malfunction, overheating, increased wear and tear

## Safety Instructions



• **INGESTION HAZARD: DEATH** or serious injury can occur if ingested.

• A swallowed button cell or coin battery can cause **Internal Chemical Burns** in as little as **2 hours**.

• **KEEP** new and used batteries **OUT OF REACH OF CHILDREN**

• **Seek immediate medical attention** if a battery is suspected to be swallowed or inserted inside any part of the body.

- Regularly check the entire electrical system for damage, especially to cables, plugs and housings. If the battery charger is damaged, it must not be used until it has been repaired.
- The pedelec is not intended for use by persons (including children) with reduced physical, sensory or mental capabilities, or lacking the required experience and knowledge, unless supervised or having received instructions concerning use of the product by a person responsible for their safety.
- Do not allow children to play near the pedelec.
- Do not modify the system yourself. Doing so may lead to system malfunctions.
- The product is designed to be fully waterproof so as to withstand wet weather riding conditions. However, do not deliberately immerse it in water.
- Do not clean the pedelec using a high-pressure cleaner. If water gets into any of the

components, operating problems or rusting may result.

- When shipping the pedelec on a vehicle exposed to rain, remove the battery and store it in a safe place to stop it from getting wet.
- Handle the pedelec carefully, and avoid subjecting it to any strong impacts.
- Important information given in the user manual may also be found in product labels.
- When using or giving out a spare key for the battery, be sure to provide the number on the battery key. Please keep the number in your mind or your notebook.
- Use a wrung-out damp cloth to clean the battery casing.
- Natural wear and tear due to normal use and aging is not within our scope of our quality warranty.
- Please contact your dealer for software updates.
- If you have any questions regarding maintenance and use of the pedelec, please contact our service hotline (Germany: +49 721 97902560, Austria: +43 1 9073366, Poland +48 22 738 64 60, Czech Republic +800 01 01 01, Croatia/Denmark: +800 3279 7834).

## Intended use

The electrical components have been solely designed and approved for use in electrically assisted bicycles, i.e. so-called pedelecs or EPACs. They are not to be used for any other purpose. It is not permissible to use it for competitions or commercial purposes.

## Maintenance and upkeep



Before performing any kind of work on your pedelec, turn off the electric unit and remove the battery. Not doing so may result in serious injury and/or electric shock



The electrical system of your pedelec is very powerful. If you notice any damage to the electrical system, remove the battery immediately. After a fall or accident, live components may be exposed. If you have a question or a problem, please contact our service hotline. A lack of expertise can lead to serious accidents.



Only perform operations described in this manual. Do not interfere with or modify the system. You should not disassemble or open any modules.



Keep the all components of the electrical system clean. Clean gently with a damp, soft cloth. The components must not be immersed in water or cleaned with a water jet or steam jet. If the components are no longer functional, contact your dealer.



Do not clean the pedelec with a steam jet, high-pressure cleaner or water hose. Water may seep into the electrics or drive and destroy the equipment.



The frequency of maintenance will vary depending on riding conditions. Periodically clean the chain using an appropriate chain cleaner. Do not use alkaline or acidic cleaning agents to remove rust under any circumstances. If such cleaning agents are used, they may damage the chain and serious injury may result.



Only have maintenance, repairs and repair work carried out by qualified personnel and only with original spare parts. If you have a flat tyre or a technical problem, have the repair work carried out by an expert/Fischer's customer services technician.

## Riding a pedelec

### How your pedelec works:

The drive is activated as soon as you begin to pedal. The amount of assistance depends on the settings you have chosen. The drive unit turns off as soon as you stop pedalling or reach maximum speed (25 km/h). The assistance is automatically reactivated as soon as the speed is below the maximum assistance speed and you reapply pressure to the pedal.

How to most efficiently use your pedelec engine:

- Always select the optimal gear and keep your pedalling rate between 60–90 rpm.
- Start with the low gears.
- As soon as your pedalling rate becomes too high, shift to the next higher gear.
- As soon as your pedalling rate becomes too low, shift to the next lower gear.
- If your pedelec uses a hub gear, reduce your pressure on the pedal before shifting gears.

### Your pedelec's range



It is best to charge your battery while it is warm and set it just before you start a journey.

The battery only reaches full range and capacity when you have travelled around 250 km with it and have always charged it properly.

The battery's drain cycle may be effected by:

- **Assistance level:** The higher the assistance level used, the higher the power consumption and the lower the range.
- **Riding style:** With the optimal use of gear shifting, you can save energy. In lower gears, you need less power, less support, and the drive of your pedelec consumes less energy.
- **Ambient temperature:** Batteries discharge faster at cold outside temperatures and have a shorter range.
- **Terrain:** In hilly terrain, more energy is needed so the range goes down.
- **Weather and vehicle weight:** In addition to the temperature, wind conditions can also have an effect on the range. A strong headwind requires more power when cycling. Bags and luggage will increase the weight, therefore more force is required.
- **Technical condition of your pedelec:** Air pressure that is too low in the tyres increases driving resistance, especially when riding over a smooth surface, such as tarmac. The range of your pedelec can be reduced by a rubbing brake or a poorly maintained chain.
- **Charging status of the battery:** The charge state indicates the amount of electrical energy that is stored in the battery at any given time. More energy means more range.

You must first ride about one kilometer before the remaining range will be displayed.

## Before the first ride



Read the entire original operating instructions and the operating manuals from the manufacturers of the individual components that were supplied with your pedelec or are available online.

- Charge the battery until it is fully charged.
- Ensure that the battery is properly inserted and locked.

## Before each ride

Do not use your pedelec if you think it may not be in perfect condition. Contact our service hotline. Be sure to have a specialist check all of the bike's important parts on a regular basis, especially if you ride your pedelec intensively. A component may unexpectedly begin to malfunction if you use it beyond its lifespan or recommended period of use. This may lead to accidents and serious injury.

## Electrical system



Modern pedelec technology is high tech, and working on pedelec parts requires expert knowledge, experience and specialist tools. Do not do any work on your pedelec yourself. Contact our service hotline (+49 721 97902560).

The electrical system includes the following components:

- Display
- Control unit
- Battery
- Drive unit
- Charger
- Sensors
- Controller

## Important Instructions



The electrical system of your pedelec is very powerful. If you notice any damage to the electrical system, remove the battery immediately. After a fall or accident, live components may be exposed. If you have a question or a problem, please contact our service hotline. A lack of expertise can lead to serious accidents.



Before performing any work on your pedelec, disconnect the electrical system and remove the battery.



Do not clean the pedelec with a steam jet, high-pressure cleaner or water hose. Water may seep into the electrics or drive and destroy the equipment.



The operating temperature should be between -15°C and +60°C. The recommended storage temperature is between -10°C and +35°C



Only perform operations described in this manual. Do not change the device. You should not disassemble or open any modules.

Replace parts that are defective or worn, such as the battery, charger, cable, with original spare parts produced by the manufacturer or parts recommended by the manufacturer. Otherwise, any guarantees and/or manufacturer's warranties will be voided. If non-original or incorrect spare parts are used, the pedelec may not function correctly. Improper operation of the drive system and changes made to the battery, charger or motor may result in injury or costly damage. In this case, the manufacturer declines any liability for

the damage caused. Changes to the electric system may result in criminal prosecution. This may be the case if the maximum assisted speed is modified.

## Operating display and display Screen



Your pedelec can be equipped with various displays and control units. Take into account the functional descriptions and operating instructions in the chapter "Displays and Settings" on page 17.

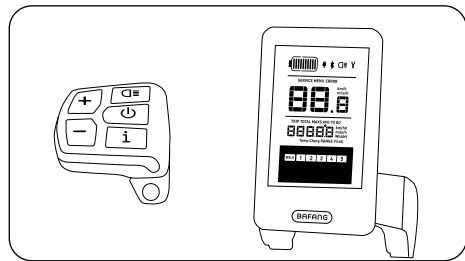

## Battery



Your pedelec can be equipped with different batteries. You will find more detailed information and specifications in the chapter "Technical Data" on page 48 and in the chapter "Operation" on page 10.

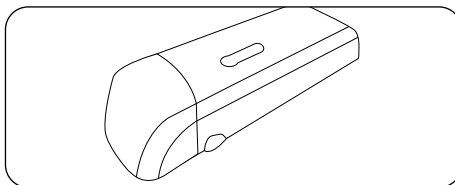

Read the indications printed on the external label of the battery before using the battery.

### Rechargeable Li-Ion Battery

Model No: XYZ  
Nominal Voltage: 48V DC  
Energy: 556.8 Wh  
Capacity: 11.6 Ah  
Cell designation: 13ICR19/66-4

#### Safety advices for Lithium-Ion batteries

Don't crush Don't heat or incinerate Don't short-circuit Don't dismantle Don't immerse in any liquid it may vent or rupture

#### Respect charging instructions

Charge 0 to 50 °C Discharge -10 to +60 °C  
Made in Germany  
GEB 15-W5/Art.: 14091-3/F119205



Sample illustration



Use only original chargers from the manufacturer to charge the battery.

- The battery is not fully charged when delivered. Recharge the battery completely before the first use and before storing.
- Under normal operating conditions, immediately charging the battery after each use will increase the battery's lifespan. Allow the battery to cool down for approximately 30 minutes before charging. Never allow your battery to drain completely. Recharge your battery even after using it for a short time. The service life of the battery is reduced when it is frequently fully discharged during later use.
- Do not charge the battery longer than instructed in the table found on page 48 in chapter "Technical characteristics".
- If the battery is completely discharged, charge it as soon as possible. Leaving the battery uncharged for long periods of time will damage its capacity.

## Safety Instructions



Risk of fire or explosion if battery is used with an incompatible system. Do not open, disassemble or pierce battery due to risk of short circuit, fire or explosion. If the battery is dropped or subjected to any other form of strong impact, discontinue its use and contact our service hotline. Only use the original charger as supplied with battery due to risk of fire or explosion. Disposal of used batteries should follow locally enforced regulations. Please carefully read the manual before use.



On some models, the rechargeable battery must be actively locked with the key when it is inserted. You may only drive off when the rechargeable battery is securely locked and the key has been removed.

- Do not drop or throw the battery. Avoid any strong impacts. This may result in fluid leakage, fire or explosion.
  - Do not apply force to the battery. If the battery becomes deformed, the built-in safety mechanism may be damaged. This may result in fire or explosion.
  - Do not use the battery when damaged. The battery fluid may leak, and it can cause loss of vision if it comes into contact with your eyes!
  - Remove the battery from the pedelec if you want to transport it (e.g. by car).
  - Also remove the battery before any work on the pedelec is performed, e.g. maintenance, installation. You are at risk of injury or electric shock if you accidentally press the on/off switch.
  - Never open the battery. Doing so may cause a short circuit. Any warranties or guarantees are void if the battery has been opened.
  - Do not store or carry the battery with metal objects that can cause short circuits (e.g. paper clips, nails, screws, keys, coins). A short circuit may result in burns or fire.
  - Keep the battery away from heat sources, such as strong sunlight and fire. Failure to do so may result in an explosion.
- Do not expose the battery to water or other liquids. Contact with them may damage the battery's safety circuit and safety mechanism. This may result in fire or explosion.
  - Do not clean the battery with a high-pressure washer. Use a damp rag when cleaning the battery. Never use aggressive cleaning solutions.
  - If improperly used, the battery may leak fluid. This may result in skin irritation and burns. Avoid contact with the battery fluid. If you do come into contact with it, rinse the fluid off with plenty of water. In case of contact with eyes, seek medical attention.
  - Fumes may be released in the event of damage and/or improper use. Provide fresh air and seek medical attention in the event of any complaints.
  - The battery must be fully snapped into place and locked in the holder before beginning a journey, you may otherwise lose the battery while riding.
  - Avoid deep discharging the battery. Doing so will result in irreversible cell damage.
  - The battery is only suitable for use with electric bicycle drives from pedelecs. Improper use or handling may result in injury or fire. Fischer is not liable for any damage resulting from improper use.

## Battery storage



If you do not use your pedelec for an extended period of time, remove the battery, charge it (60–80 %) and store it separately in a frost-free, dry room.

- Avoid direct sunlight. This can lead to overheating, distortion, rupturing, poorer performance and a shorter lifespan of the battery.
- To prevent deep discharge, the battery will go into sleep mode after a certain time. The battery changes from this state when it has been briefly charged.
- Do not expose the battery to temperatures outside the permissible storage temperature range of -10 °C to 35 °C. Note that temperatures of around 45 °C are common near heaters, in direct sunlight or in over-heated vehicle interiors.
- When storing the battery for a long period, make sure it is charged to at least half its capacity, and charge it again three months later. Do not wrap it with conductive material, as to do so will cause damage due to direct contact between metal and the battery.



If you notice the battery becoming hot during use, charging or storage, developing a strong odour, changing appearance, or any other abnormality, do not continue to use the battery. Contact our service hotline.



## Battery wear



The battery can be fully loaded approximately 750 times and partially loaded approximately 1,000 times. The battery capacity decreases during this time, making the battery drain faster with the use of the pedelec's motor assistance. This does not constitute a defect. You should then replace the battery. If the range is still sufficient, you can continue to use it.

The battery life depends on various factors:

- The number of charging operations (about 1000 charging cycles)
- The age of the battery
- Storing and Operating Conditions

Of course, your battery will deteriorate and capacity will be lost even if you do not use the battery.

The lifetime of your battery can be lengthened by the following measures:

- Charging your battery after every ride, even short trips. Lithium-ion batteries are not subject to a memory effect.
- Avoiding driving in high gears with high levels of push-assistance.

## Charger



The chargers were specially developed for charging lithium-ion batteries. They are equipped with an integrated fuse and protection against overcharging.

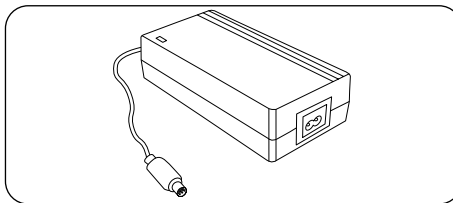

## Operating Instructions



Read the indications on your charger's external label before using the battery.



### Li-ion Battery Charger

MODEL: XYZ  
INPUT: AC100V-240V~1.8A MAX  
47-63Hz

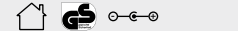
OUTPUT: 42.0V  $\overline{\text{---}}$  2.0A  $\text{---}$



- CHARGING
- CHARGE-FULL OR DISCONNECT

 CAUTION: TO REDUCE THE RISK OF ELECTRIC SHOCK; DO NOT REMOVE COVER (OR BACK). NO USER-SERVICEABLE PARTS INSIDE. REFER SERVICING TO QUALIFIED SERVICE PERSONNEL. BEFORE CHARGING READ THE INSTRUCTIONS! FOR INDOOR USE, OR DO NOT EXPOSE TO RAIN 

Sample illustration



The charger must not be taken apart. Maintenance work should only be done by qualified service workers. Make sure to read the information about your battery charger before charging your battery for the first time. Unplug the charger before attaching or removing the battery from the charger. Flammable gases can leak out. Prevent flames and sparks.



Keep the charger away from children and animals. Small children and animals may damage the device or the cable while playing. This can lead to an electric shock, a malfunction or a fire.

- The charger must not be used by children, or by persons with limited physical, sensory or mental capabilities, unless under the supervision of a responsible adult.
- Make sure the charger is clean to avoid risk of electric shock.
- Do not use your charger in humid or dusty places.
- Avoid direct sunlight.
- Only use the charger that came with your pedelec or one produced by the same manufacturer.
- Don't cover the charger while it is in use. It could otherwise short circuit or cause a fire.
- When you clean the charger, unplug it from the electrical socket first.
- Stop charging the battery if the charging cycle is taking longer than the length listed in the table found on page 48 under the chapter "Technical Data".
- After charging, if not in use, remove the battery from the charger and unplug the charger.

## Drive unit



Your pedelec might be powered by a hub motor in the front wheel, a central motor or a hub motor in the rear wheel. All types have a maximum average performance of 250 watts.

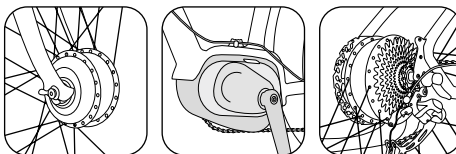

Keep in mind that the motor of your pedelec can heat up during long up-hill runs. Do not touch the motor, as you may get burnt.



In hub motors, you hear a quiet driving noise during operation. This noise may grow louder with increased strain and is completely normal.



Note that if the road surface or ground are slippery (due to rain, snow, sand, etc.), there is a risk that the drive wheel of your pedelec may skid and slide.

## Operation



Depending on the pedelec model, a 36 V or 48 V battery may be used. A sticker at the bottom of the battery indicates which type of battery is used.

## Battery Pack in carrier rack



The luggage rack battery is secured by a lock on the left side. The lock is integrated into 36V models and located below the battery rail for 48V models. Remove the key to avoid losing or breaking it.

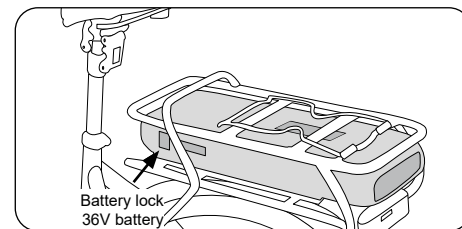

Sample illustration

## Removing the battery

1. Turn off the electrical power unit system before removing the battery.

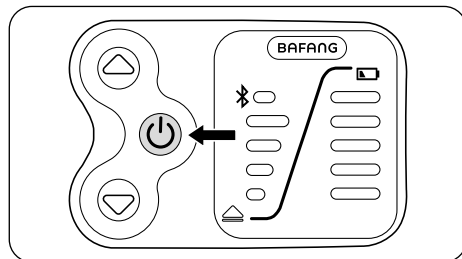

2. Insert the key into the battery lock. Turn the key anticlockwise towards the left. The key must be held in this position in order to **remove** the battery!

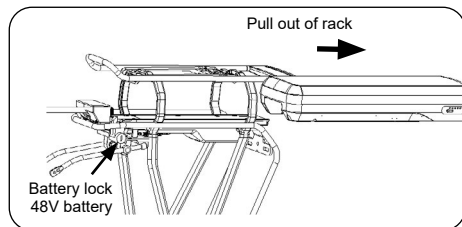

3. Remove the battery from its holder. Removing the battery requires some force.



Hold the battery tightly as it is heavy

## Installing the battery

1. For the battery to be inserted, the lock must be unlocked. You can lock and unlock the battery by turning the key provided.

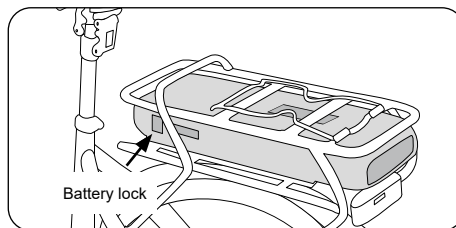

2. Slide the battery along the rail track as far as possible into the connection device.

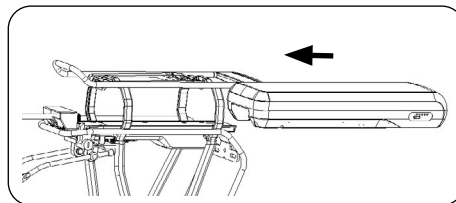

The **36V battery** latches audibly and closes automatically. Additional locking is not necessary or not possible.

The **48V battery** does NOT latch. The battery must therefore be inserted with sufficient force up to the final point, where it is in contact with the limit stop. Warning: It is essential to secure the battery before each drive by inserting the key, turning it clockwise and removing it.

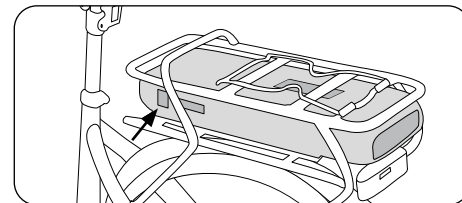

When inserting the battery, ensure that it fits appropriately into the guide structure, as safe locking is otherwise not assured. For correct insertion, the battery must be inserted and locked from the rear of the casing as far as it will go. Without contact with the battery, the electric drive of your pedelec will not work.

## Frame battery

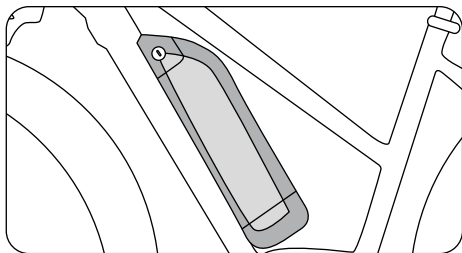

### Removal

1. Turn off the electrical power unit system before removing the battery.

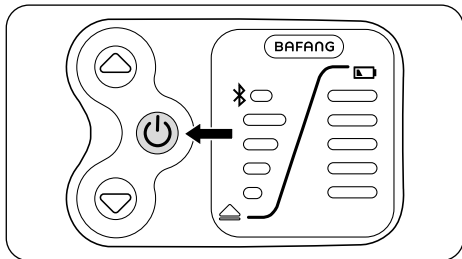

2. To remove the battery, insert the key into the battery lock and turn it towards the left.



The key must be held in this position.

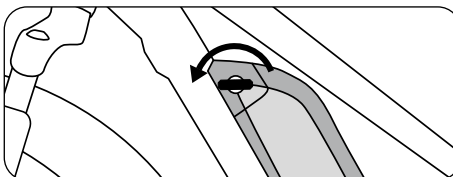

3. Tilt the battery to the right.



During removal, take care that an angle of 15° is not exceeded, as the battery holder might otherwise get damaged.

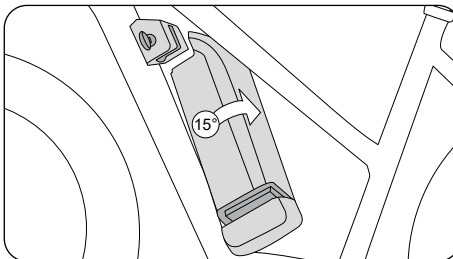

4. Slightly lift the battery and detach it from the battery holder.



Hold the battery tightly as it is heavy.

### Insertion

1. Hold the battery slightly tilted to one side. Place the right bottom edge of the battery on the battery holder

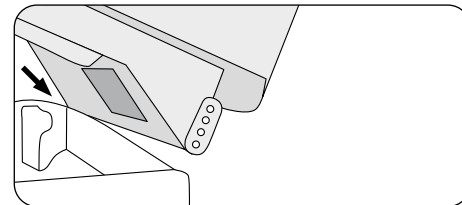

2. Then tilt the battery sideways into its structure.

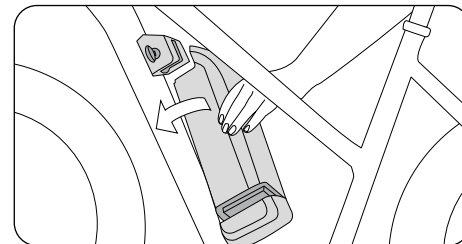

3. Lock the battery lock with the key and remove the key before setting off. The rechargeable battery must be correctly and fully engaged.

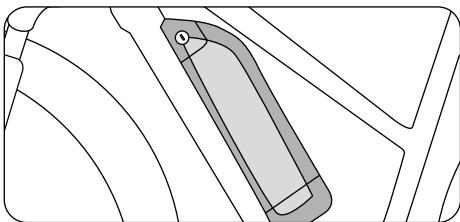

**Integrated battery**

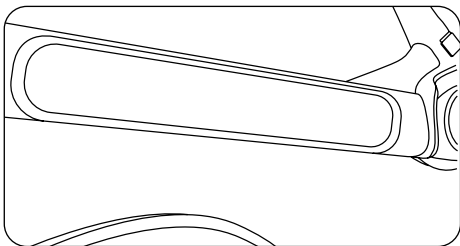
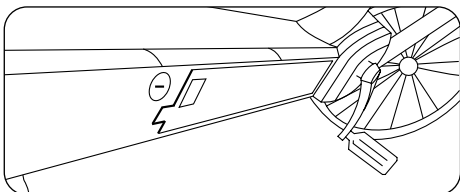

### Removing the battery

1. Turn off the electrical power unit system before removing the battery.

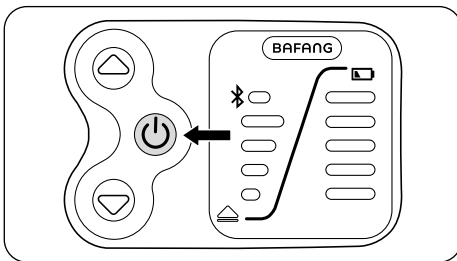

2. Insert the key into the battery lock. Turn the key anticlockwise towards the left until it reaches the limit stop ①. Then the battery detaches from the battery holder ②.

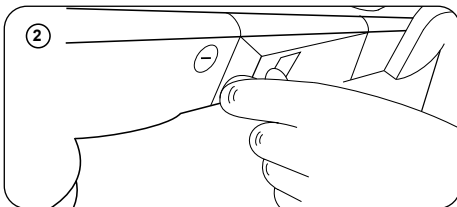
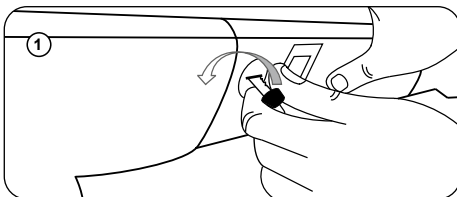

3. Pull the battery out of the battery holder.

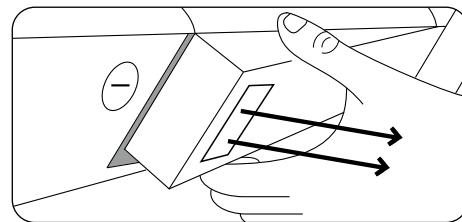

Hold the battery tightly as it is heavy.

### Insertion

1. Hold the battery slightly tilted to one side. Place the left, bottom edge of the battery on the battery holder.

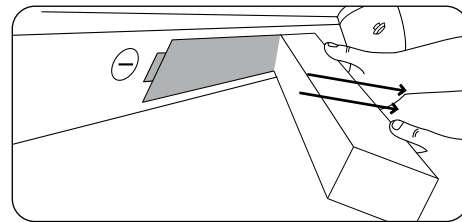

2. Then tilt the battery sideways into its guide structure.

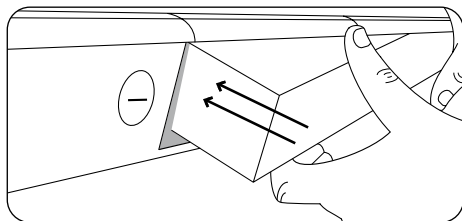

3. Lock the battery lock with the key and remove the key before setting off. The rechargeable battery must be correctly and fully engaged.

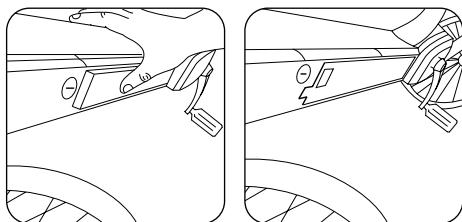

When inserting the BN 23 battery, make sure that the rubber lip of the battery seal rests against the outer side of the frame and is not squeezed.

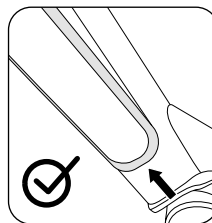
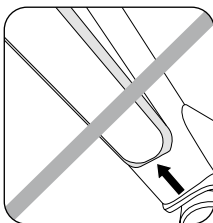

### Charging the battery



You can charge your battery both while mounted on the pedelec and removed.

If your model is equipped with the "BN 23" battery, there is an external charging socket on the seat tube of the pedelec so that you can charge the battery while it is in the pedelec.

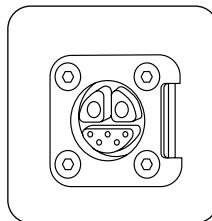
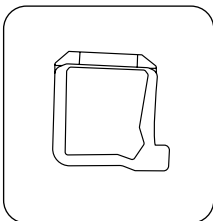

Lithium-ion batteries are not subject to a memory effect. You can recharge your battery at any time, even after short trips.

Charge your battery at temperatures between 0°C and 45°C (ideally at room temperature or 20°C). Give the battery sufficient time before charging to reach this temperature.



Read the instructions on the charger before charging.

1. First insert the plug of the charging cable into the charging socket, then the plug the charger into a socket.
2. As soon as the charger is connected to the power supply, a red LED will light up.

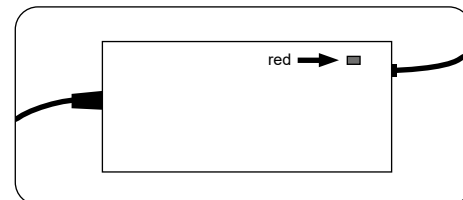

- When charging is complete, the LED changes from red to green. As soon as the battery is fully charged, first remove the plug from the power outlet and wait until the LED on the charger goes out. Only then should you remove the plug from the battery.

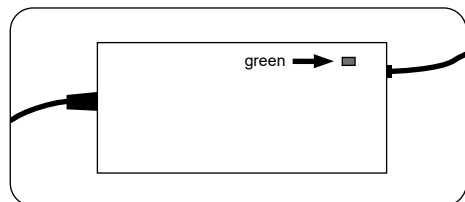

Charging time depends on various factors. It can vary greatly according to the temperature, age, usage and capacity of the battery. Information about your battery's charging time can be found in the technical information regarding your battery. When the battery is fully charged, the charging process is automatically terminated. Unplug the plug from the battery and the power outlet.

### Safety Instructions



Only use the charger designed for the battery.

Make sure you use the correct mains voltage. The required mains voltage is indicated on the charger. It must comply with the voltage of the current source. Chargers marked 230V can also be operated at 220V.

- Do not touch the power plug with wet hands. There is a risk of electric shock.
- Note: Sudden temperature changes can cause condensation to form on the battery. Avoid this by storing the battery in the same place it is charged.
- Before use, check that the charger, cable and plug are not damaged. If damage occurs, do not use the charger. There is a risk of electric shock.
- Charge the battery in well-ventilated rooms only.
- Do not cover the charger and/or battery during charging. There is a risk of over-heating, fire, or explosion.
- Only charge on a dry, non-flammable surface.



The battery has to be recharged completely at least every 3 months, in order to avoid damaging or destroying the cells.



If the charging cycle is taking longer than usual, the battery may be damaged. In this case, immediately stop charging. You will find the charging times in the table on page 48.

Error description	Cause	Solution
The LED does not light up.	The mains plug is not properly connected to the power supply.	Check all connections and whether the charger is properly plugged into the power supply.
The LED does not light up even after checking the power supply.	The battery may have a malfunction.	Contact our service hotline.
LED flashes red.	Wrong battery/charger combination (36V/48V), other defect.	Contact our service hotline.
LED does not change immediately from red to green, even when the battery is fully charged.	The battery may be defective.	Contact our service hotline.

### Inserting the battery

The aluminum cover must be removed prior to inserting the battery of your pedelec. Between the cover and the battery, you will see three small screws under the rubber seal.

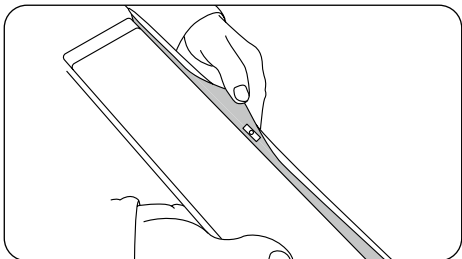

Remove the cover using a suitable tool. To do this, you need to turn the screws counterclockwise. Unscrew them all the way and store them safely.

Move the cover and the battery against each other as far as possible.

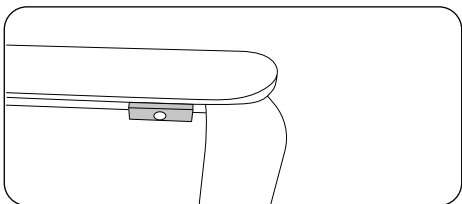

Now you can lift off the cover.

Insert the battery only.

When you get a repaired or new battery, place the two parts on top of each other in the position in which you separated them. Move the cover and battery until the holes for the screw are aligned again. Turn the screws in clockwise. Gently hand-tighten them.

Now you can put the battery back into the pedelec.

## LED charging state display

### 36 V Luggage rack battery

To display the charge state, briefly press the test button. Keep pressing the test button to check the charging state. If the battery is full, four of the five LEDs will light up in green. The last LED turns red as soon as the battery needs charging.

### 48 V Luggage rack battery

To display the charge state, briefly press the test button. Hold down the test button to check the charging state. When the battery is fully charged, all five LEDs light up in blue. As soon as the battery is empty and needs charging, only the last LED will light up blue.

### Frame battery

To display the charge state, briefly press the test button. Hold down the test button to check the charging state. When the battery is fully charged, all five LEDs turn blue. As soon as the battery is empty and needs charging, only the last LED will light up blue.

### Integrated battery – General

Briefly press the test button of the battery to check the charging state. When the battery is fully charged, all five LEDs light up in blue. As soon as the battery is empty and needs charging, only the last LED will light up blue.

### All batteries – deep sleep mode

In addition to the functions listed above, all battery variants also come with an option which allows you to put the battery into deep sleep mode.

To do this, you must remove the battery from the pedelec.

Activate deep sleep mode by pressing the test button for 15 seconds. Deactivate deep sleep mode by connecting the battery to the charger. The deep sleep mode reduces the current flow inside the battery to a minimum and is suitable for winter storage. Nevertheless, the battery must be charged at regular intervals to maintain the capacity values mentioned above.

## Switching the electrical system on and off

Press the “On/Off” button on your external operating unit to switch on the electrical system.

To turn it off, push and hold down the same key until the system turns off.

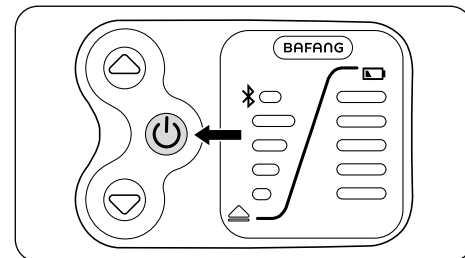

### Requirements:

The following requirements must be met before you can activate and use your pedelec:

- A sufficiently charged battery must be used.
- The battery must be inserted correctly into the battery holder.
- The motor, control unit, battery, etc. must all be connected correctly.





Always squeeze the brakes of your pedelec before placing a foot on the pedal. The electric engine starts working as soon as you begin to pedal. This boost is surprising to begin with, and can lead to falls or cause dangerous traffic accidents and injury to occur.

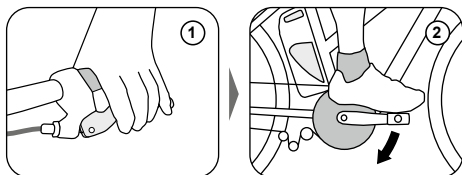

## Displays and settings



Your pedelec can be equipped with various displays and control units. If there is a sticker attached to the cable of your display, do not remove it. It is needed for any service work.

## LED 350 control unit and 550 control unit

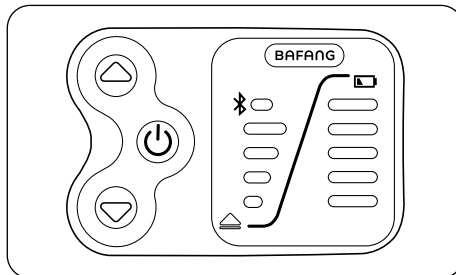

The control unit is mounted next to the left handle. It displays all information with LEDs. The 550 control unit offers a Bluetooth function in addition to the information of the 350.

## Functional overview and operation

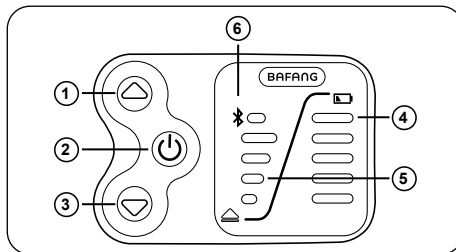

1. button  
Keep the button pressed in order to switch the system on/off.
2. button  
Pressing it briefly increases the motor assistance. Pressing and holding it switches the display lighting and the pedelec lighting on and off. The rear light always turns on when the electrical system is turned on.
3. button  
Pressing it briefly reduces the motor assistance. Press and hold to activate the push assistance. To activate the push assistance, select level 0. Press the button. The top LED flashes. Keep the button pressed to activate the push assistance.
4. The charging status of the battery is indicated by five LEDs. If all five LEDs light up, the battery is full. If the lowest LED flashes, the battery is empty and must be charged.
5. The motor support is indicated by five LEDs. If one LED is lit, you will receive little support. If five LEDs are lit, you will receive strong support. If no LED is lit, you will not receive any motor support. To activate push assistance, tap the button five times. The LED for the highest level will flash briefly. Keep the button pressed. All LEDs for the motor support will flash one after the other. Push assistance is now activated. To deactivate push assistance, release the button.
6. The LED 550 display has a Bluetooth function and can be connected to the FISCHER E-Connect app.

## Error codes

In the event of a technical problem, an error code will appear on your display. The two lower LEDs for the motor support level will flash on the display to indicate the code.

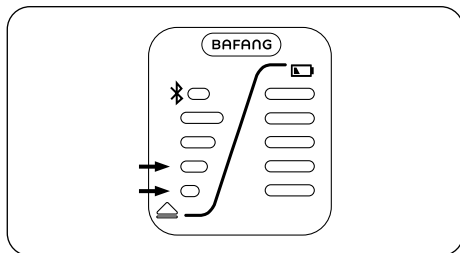

The lower LED stands for the tens digit and the second LED for the ones digit. For example, to display error 04, the lower LED will not flash and the second LED will flash four times.

Descriptions of the individual error codes can be found in the table on page 27.

## LCD 850 and LCD 1350

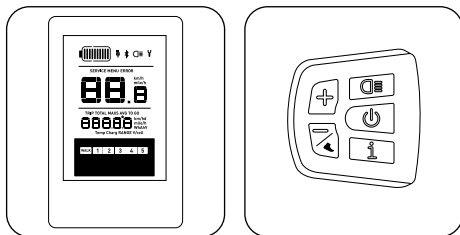

## Control unit for both displays

### Functional overview and operation

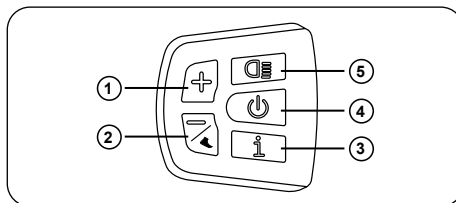

1. "+"-button  
Press to increase motor support.
2. "-"-button  
Press to reduce motor support.  
To activate the push assistance, select assistance level "0" with the "+" button. Quickly press the "-" button. The "Walk" symbol appears. Keep the "-" button pressed to activate the push assistance.
3. Information button  
Pressing it briefly makes the information line on the display show different information. The shown or chosen setting is confirmed and the next menu point is chosen when this button is briefly pressed. Pressing it briefly twice confirms the selection and returns to the normal display.
4. "⏻" button  
Keep pressed to switch the pedelec on/off.
5. Light button  
Keep pressed to switch the display and any pedelec lighting which may be available on/off. The rear light always turns on when the electrical system is turned on.

## Display

### Functional overview

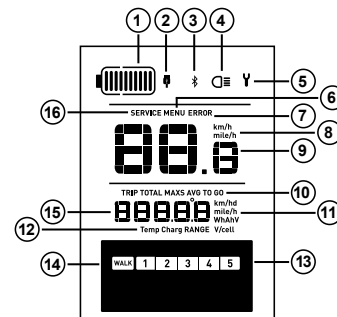

1. Charge status of the battery  
This shows the current charge status of the battery. The battery is empty when only the frame flashes.
2. USB connected  
This symbol lights up as soon as a USB device has been connected for charging.
3. Bluetooth Function (only LCD 1350)  
The display can be connected via Bluetooth to the FISCHER e-Connect app and a heart rate strap.
4. Illumination activated  
This symbol lights up as soon as the display lighting and any permanently installed lighting system have been activated.
5. Indicates a technical error  
This symbol is shown as soon as an error occurs.

6. Menu  
Only pops up when you are in menu mode.
7. Fault display  
An error code is displayed.
8. Unit  
It shows the measuring unit used to measure speed.
9. Main display  
It primarily shows the speed. It is used in the menu for navigation and setting purposes.
10. Information line  
A short press of the “i” button changes to the following displays:
  - TRIP = Trip counter
  - TOTAL = Total kilometres
  - MAXS = Max speed
  - AVG = Average speed
  - Range = Remaining range
  - W = Motor support in watts
  - H = Heart rate
  - C = Calorie consumption (sofern vom Motor unterstützt)
11. Units displayed on the information line (15)
  - km/h = When kilometres are selected as the unit.
  - mph = When miles are selected as the unit.
  - Wh, Ah, V = Units for items in the table.
  - V/cel = Units for items in the table below.
12. Units for information display for the table below. Table can be found at the end of the display settings.
  - Temp = Temperature in degrees Celsius
  - Charge = Battery charge status in percent form
  - Range = Range

CHC	Hardware version of the controller
CSC	Software version of the controller
DHC	Hardware version of the display
DSC	Software version of the display
BHC	Hardware version of the Battery Management System
BSC	Software version of the Battery Management System
SSC	Torque sensor software version
B01	Current temperature of the battery (in °C)
B04	Current voltage of the battery (in V)
B06	Average power consumption of the system (in A)
B07	Usable remaining capacity of the battery (in Ah)
B08	Capacity of the battery when fully charged (in Ah)
B09	Current battery charge status that can be used by the motor (in %)
B10	Current total charge status of the battery (in %)
B11	Charge cycle of the battery
B12	Service values

B13	Service values
D00	Number of battery cells per series connection
D01-D13	Voltage of the battery cells per series connection
E00-E09	Error code log

13. Assistance level  
It shows the currently selected support level. The motor support is switched off when no number is shown.
14. Walk  
Is only shown when the pushing assistance is activated.
15. Information line
16. Service  
As soon as an inspection of the pedelec becomes due, an appropriate note will flash 3x when the system is switched on.

## Settings



Do NOT change the settings while riding your pedelec.

This LCD offers you various personalization options. To do this, first switch on the display by pressing and holding the “⏻” button on the control unit for approximately two seconds.

Then, quickly press the “i” button twice in a row. You can navigate between the settings by pressing the “i” key. Now you can select the values in the instances where the settings can be modified.

### *Reset the daily information*

The first menu can be used to reset trip information such as the “trip meter”. Use the “+” button or the “-” button to select “y/yes” or “n/no” on the display. If you select “y”, all daily information will be deleted. Confirm your selection by clicking the “i” button twice in rapid succession. Now the daily information will be set to zero, and you will return to the main view.

### *Select the speed unit*

The display will offer the possibility to select kilometres or miles as the display unit. Use the “+” or “-” button to select the desired unit, km/h or mile/h. Confirm your selection by clicking the “i” button twice in rapid succession. You will now return to the main view.

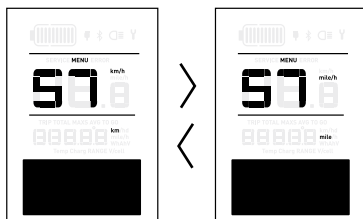

*Select the support level*

Navigate with the “i” key to the menu item “CP”. Briefly press the “⏻” button. Now the percentage value of the support level flashes. Use the “+” and “-” buttons to change the support level. This allows you to adjust the strength of all support levels one after the other. Once you have set all the support levels, confirm the settings by pressing the “i” button twice in quick succession. You will now return to the main view.



When setting the strength of support, the percentage (i.e. the support strength) must be set to a higher value in higher support levels than in lower levels.

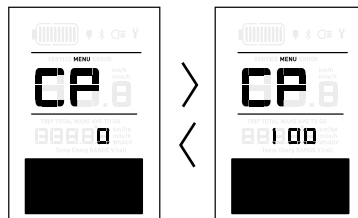

### *Adjusting the maximum speed*

Your pedelec offers the possibility to set the maximum speed up to which the motor will provide assistance. This ranges from 12 km/h to 25 km/h.

Use the “i” button to navigate to the “SPL” menu option. Briefly press the “on/off” button. The set speed will now flash. Use the “+” and “-” buttons to adjust the speed. Once you have set the speed, confirm it by pressing the “i” button twice in quick succession. The selected setting only starts working after the pedelec has been restarted.



### *Brightness sensor*

Your display has a brightness sensor on the back. In the dark, it automatically switches on the display lighting as well as the permanently installed lighting system, if available. You can choose at which level of darkness the lighting is to be activated. Select the desired sensitivity level with the “+” or “-” buttons: 0 = Brightness sensor is off, 1-5 brightness sensor is on.

The higher the number, the more sensitive the sensor and the earlier the lighting system will be activated. Confirm your selection by clicking the “i” button twice in rapid succession. You will now return to the main view.

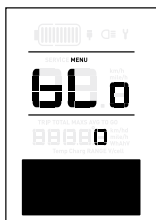

### Background lighting

The intensity of the display background lighting can be set at five levels. Select the desired brightness from 1 to 5 by using the “+” or “-” buttons on the display. The higher the number, the brighter the lighting. Confirm your selection by clicking the “i” button twice in rapid succession. You will now return to the main view.

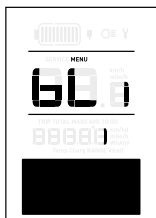

### Switch-off time

Your pedelec provides an automatic switch-off function. This switch-off function is activated if the pedelec has not been used for some time. The default is 5 minutes. The time to switch-off can be adjusted between 1 and 9 minutes.

Use the “+” button or “-” button on the display to select the desired switch-off time and confirm your selection by pressing the “i” button twice in quick succession. You will now return to the main view.



### Service notification

Your system offers the possibility to activate a notification when an inspection needs to be carried out. Use the “i” key to go to the “nnA” display. Use the “+” or “-” button on the display to select “0” or “1”. Selecting “1” activates the service notification, and the message “Service” will appear on the display after every 5,000 kilometres travelled. Confirm your selection by clicking the “i” button twice in rapid succession. You will now return to the main view.

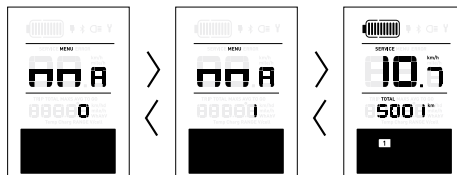

You will find more information in the settings. These cannot be changed or can only be changed by a specialist bicycle retailer.



In the event of an error, the display shows the symbol and an error number to help identify the error.





Always quote the error code when contacting our service hotline.

Description of the error codes can be found in the table on page 27.

## LCD 1050

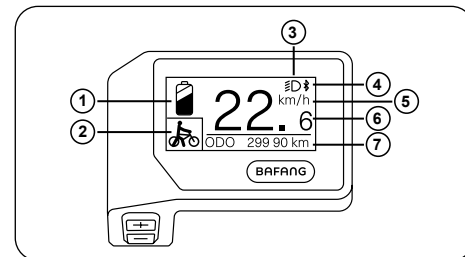
### Overview



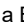

1. Battery charge level
2. Assistance level display. The  icon is displayed as soon as the push assistance is activated.
3. When the light is switched on, this icon  appears
4. The  icon is displayed when a Bluetooth device is connected.
5. Unit of speed display: kilometers or miles
6. Current speed
7. Information line

Daily distance (TRIP) – total distance (ODO) – maximum speed (MAX) – average speed (AVG) – travel time (TIME) – output power (POWER) – energy consumption (CAL) – range (RANGE) – heart rate (HR)

## Operation and display

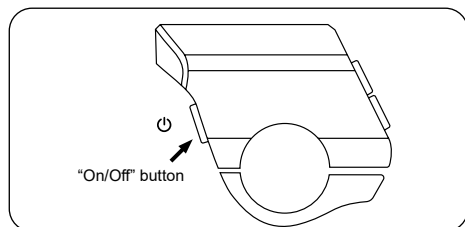
### System on/off button



To switch on the electrical system, press the “” button until the indicator appears in the display. To turn off the system, press and hold the “” button for more than two seconds until the indicator goes off.

If the automatic shutdown is set to five minutes, the display will turn off after this duration if no action is performed. This function can be changed in the settings via “Auto Off”.

### Assistance levels

By briefly pressing the “+” button or the “-” button, you can increase or decrease the strength of the motor assistance. After switching on the display, level 1 is selected by default.



### Information line

Briefly press the “” button to switch between the following displays in the info line.

Daily distance (TRIP) – total distance (ODO) – maximum speed (MAX) – average speed (AVG) – travel time (TIME) – output power (POWER) – energy consumption (CAL) – range (RANGE) – heart rate (HR)

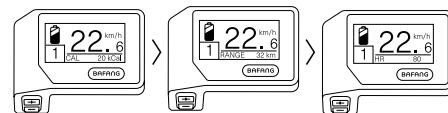

### Turning the light on/off

To turn the light on or off, press and hold the “+” button for more than two seconds. The rear light always turns on when the electrical system is turned on.

### Activating push assistance





The push assistance function works to assist you if you, for example, have to climb a steep ramp or underpass. You should not use it for riding. Push assistance can only be activated when the bike is stationary.



Push assistance is not start-up assistance! If you activate push assistance when the pedelec load is too heavy, your motor will start to stutter and may even perform an emergency shutdown!



Push assistance can only be activated when the bike is stationary.

Press the “-” button until the  icon appears. Then press and hold the “-” button. If the  icon is flashing, push assistance is activated. The motor assists you when pushing your pedelec. As soon as you release the “-” button, the push assistance is deactivated.

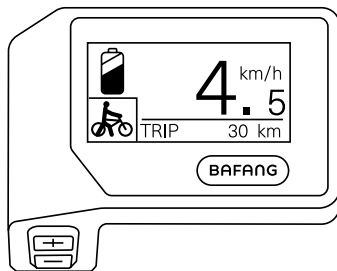

### Service



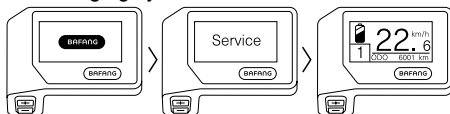



When the system is switched on, the “Service” icon appears every 5,000 km (3,100 miles) or 100 charging cycles.



When it appears, you should have your pedelec inspected by a professional. You can disable the reminder in the settings under “SERVICE”.

### Battery level indicator

This shows how fully charged your battery is. When the battery charge is below 5%, the outline of the display flashes. The battery must be charged immediately.

Capacity Range	Indicator
80% – 100%	
60% – 80%	
40% – 60%	
20% – 40%	
5% – 20%	
< 5%	 blinking

### Bluetooth function

The display can be connected to the Bafang Go app and the Sigma Heartbeat Band via Bluetooth.



### Settings



DO NOT change the settings while riding your pedelec.

With the display on, press the “+” button and the “-” button simultaneously for more than two seconds to enter the settings menu.

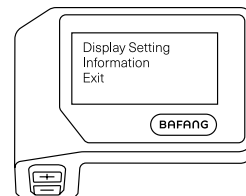

Select the desired menu option by pressing the “+” button or the “-” button.

1. Display Setting (you can configure the settings here).
2. Information (only information about your system is displayed here).
3. Exit (this option takes you back to the normal display).  
Confirm your selection by pressing the “U” button.

### Display Setting

Select "Display Setting" by pressing the "+" button or the "-" button and confirm your selection with the "⏻" button. This takes you to the sub-menu.

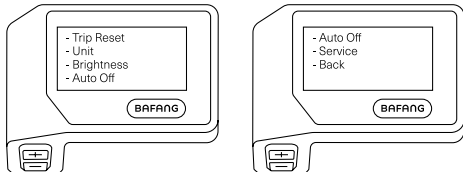

### "TRIP Reset" – Resetting daily distance

Use the "+" button or the "-" button to select the "Trip Reset" menu option and confirm your selection with the "⏻" button. Then use the "+" button or the "-" button to select "YES" or "NO". Confirm your selection with the "⏻" button to save the entry and return to the "Display Setting" menu.

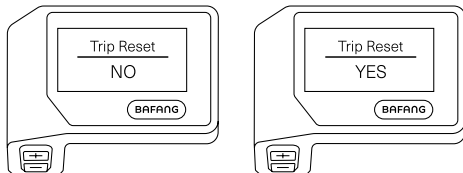

### "Unit" – Selecting the unit of speed

Use the "+" button or the "-" button to select the "Unit" menu option and confirm your selection with the "⏻" button. Then use the "+" button or the "-" button to select the "Metric" (kilometers)

or "Imperial" (miles) option. Confirm your selection with the "⏻" button to save the entry and return to the "Display Setting" menu.

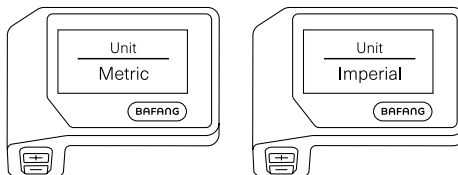

### "Brightness" – Setting the display's brightness

Use the "+" button or the "-" button to select the "Brightness" menu option and confirm your selection with the "⏻" button. Then select "100"/"75"/"50"/"30"/"10" with the "+" and "-" buttons. Select "100" for the brightest display and "10" for the dimmest display. Confirm your selection with the "⏻" button to save the entry and return to the "Display Setting" menu.

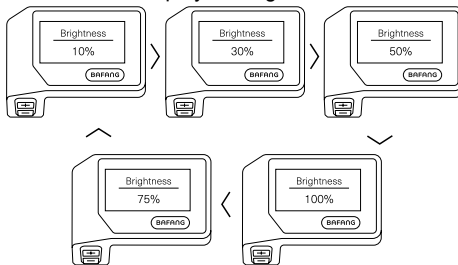

### "Auto Off" – Time until automatic shutdown

Use the "+" button or the "-" button to select the "Auto Off" menu option and confirm your selection with the "⏻" button. Then use the "+" button or "-" button to select the number of minutes before the system automatically switches off. 9/8/7/6/5/4/3/2/1 minute(s) are the available options. Confirm your selection with the "⏻" button to save the entry and return to the "Display Setting" menu.

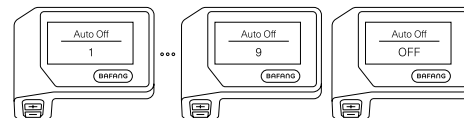

### "Service" – Activating or deactivating the notification

Use the "+" button or the "-" button to select the "Service" menu option and confirm your selection with the "⏻" button. Then use the "+" button or the "-" button to select "YES" or "NO". Confirm your selection with the "⏻" button to save the entry and return to the "Display Setting" menu.

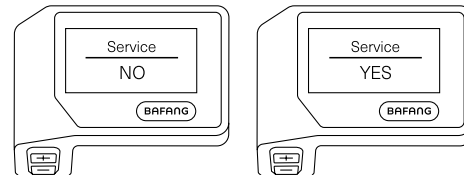

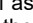
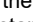

### *“Current Pow” – Setting the assistance level*

You can set the strength of the individual assistance levels here. Use the “+” button or the “-” button to select the “Current Pow” menu option and confirm your selection with the “” button. Then select the level of assistance with the “+” or “-” button. There are five levels of assistance. Confirm your selection with the “” button to save the entry and move to the next lower assistance level.

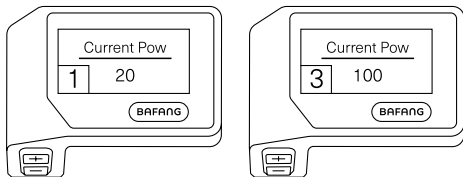

### *“Speed Limit” – Setting the shutdown speed*

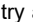
You can set the speed at which your motor assistance switches off here. The minimum possible shutdown speed is 12km/h, and the maximum possible shutdown speed is 25km/h. Select “Speed Limit” with the “+” button or the “-” button and confirm your selection with the “” button. Then select your desired value. Confirm your selection with the “” button to save the entry and return to the “Display Setting” menu. The selected setting only starts working after the pedelec has been restarted.

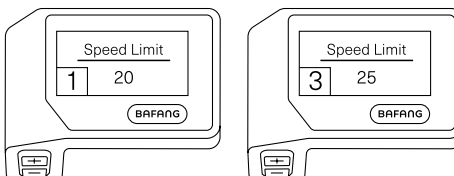

### **Information**

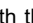
Select the “Information” menu option in the settings menu with the “+” button or the “-” button and confirm with the “” button. This takes you to the submenu.



Settings cannot be configured in the Information menu.

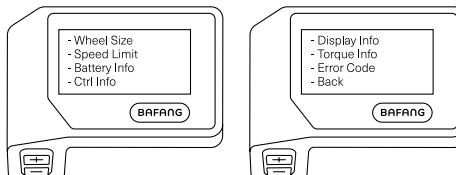

### *“Wheel Size”*

The wheel size of your pedelec is displayed.

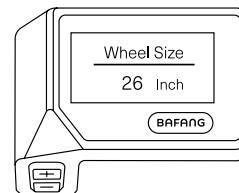

### *“Speed Limit” – Maximum speed*

The maximum motor-assisted speed is displayed.

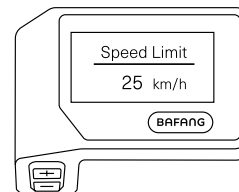

Code	Explanation
Hardware Ver	Hardware version
Software Ver	Software version
b01	Current temperature (°C)
b04	Total voltage (V)
b 06	Average current (A)
b 07	Remaining capacity (mAh)
b08	Capacity when fully charged (mAh)
b09	Relative charge status (%)
b10	Actual charge status (%)
b11	Charging cycles (number)
b12	Maximum time without charging (hours)
b13	Time since last charge (hours)
d00	Number of battery cells
d01 – d10	Voltage in cell 1-10 (mV)

#### *“Ctrl. Info” – Information about the control unit*

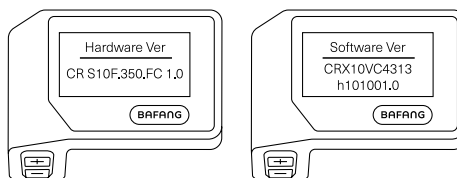

#### *“Display Information” – Display data*

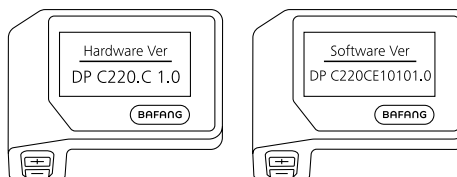

#### *“Torque Info” – Torque*

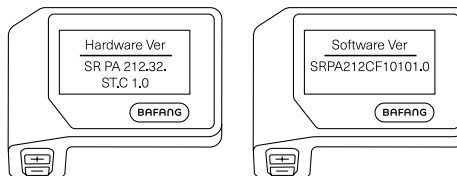

#### *“Error Code” – Error messages*

Information about the last ten error messages is displayed. “00” means that there is no error message.

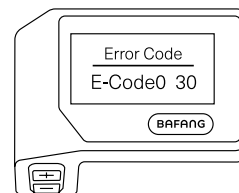

The potential error messages can be found in the table on page 27.



If an error code is displayed, first reboot your system and then follow the troubleshooting steps given in the description for the error code. Please contact our service hotline if you cannot resolve the problem yourself. Always provide the error code when contacting our service hotline.

## Error codes for Bafang displays

Error	Description	Troubleshooting
07	Overvoltage protection	<ol style="list-style-type: none"> <li>1. Remove the battery.</li> <li>2. Replace the battery.</li> <li>3. If the problem persists, please contact the Fischer Service.</li> </ol>
10	The temperature inside the engine has reached its maximum safe value.	<ol style="list-style-type: none"> <li>1. Switch off the system and let the Pedelec cool down.</li> <li>2. If the problem persists, please contact the Fischer Service.</li> </ol>
14	The temperature inside the controller has reached the maximum safe value.	<ol style="list-style-type: none"> <li>1. Switch off the system and let the Pedelec cool down.</li> <li>2. If the problem persists, please contact the Fischer Service.</li> </ol>
21	Error with the wheel speed sensor.	<ol style="list-style-type: none"> <li>1. Switch the system off and on again.</li> <li>2. Check that the magnet attached to the spoke is aligned with the speed sensor and 10 mm - 20 mm away from it.</li> <li>3. Check that the speed sensor connection is correctly connected.</li> <li>4. If the problem persists, please contact the Fischer Service.</li> </ol>
25	Error with the torque signal or torque sensor .	<ol style="list-style-type: none"> <li>1. Check that all connections are connected correctly.</li> <li>2. If the problem persists, please contact the Fischer Service.</li> </ol>
26	Error with the speed signal or torque sensor .	<ol style="list-style-type: none"> <li>1. Check that the speed sensor plug is connected correctly.</li> <li>2. Check the speed sensor for signs of damage.</li> <li>3. If the problem persists, please contact the Fischer Service.</li> </ol>

Error	Description	Troubleshooting
30	Communication failed.	<ol style="list-style-type: none"> <li>1. Check all connectors.</li> <li>2. If the problem persists, please contact the Fischer Service.</li> </ol>
33	Error with the brake signal (if brake sensors are present)	<ol style="list-style-type: none"> <li>1. Check all connectors.</li> <li>2. If the problem persists, please contact the Fischer Service.</li> </ol>
08, 09, 11, 12, 13, 15, 27, 35, 36, 37, 41, 42, 43, 44, 45, 46, 47, 48, 61, 62, 71, 81	Technical error	Please contact the Fischer Service.

## Brose Display Allround

### Overview

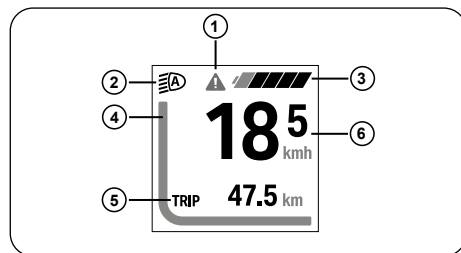

Driving mode display

1. System information (e.g. errors)
2. Lights
3. Battery charge level
4. Current engine support level
5. Trip information
6. Speed

### Operation and Display

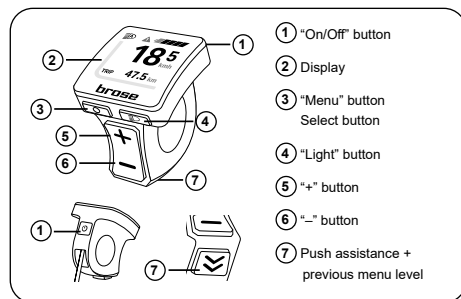

### System On/Off button

To switch on the electrical system, hold the "On/Off" button until the display lights up. To turn off the system, hold down the "On/Off" button until the display powers off.

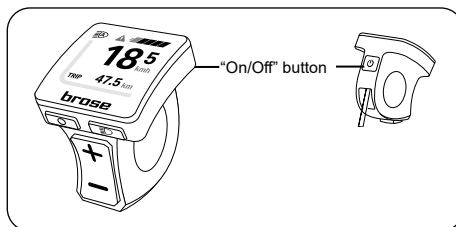

### Support levels

Press the "+" and "-" buttons to increase or decrease the strength of the engine support. During the trip, the current level is displayed as a coloured line. The selected level is also displayed as text for 2 seconds after you change the support level.

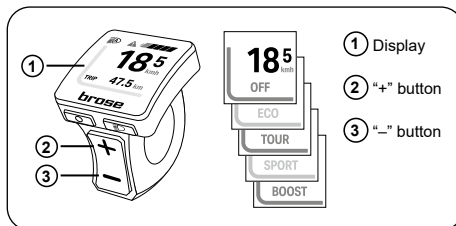

After switching to a different assistance level, the range adjustment only takes place after you have ridden a few meters with your pedelec.

### Support levels

- |                       |   |
|-----------------------|---|
| OFF                   | (grey): No engine support. Simultaneous, resistance-free cycling.   |
| ECO                   | (green): noticeable support from the engine for maximum efficiency and range.                                   |
| TOUR                  | (blue): clearly noticeable support from the engine, best suited for long trips.                                 |
| SPORT                 | (yellow): powerful support for sport cycling trips  |
| BOOST/<br>BOOST<br>FX | (red): full support for sport cycling trips on mountainous routes and in city traffic with normal battery range |

### Lights

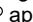
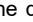
Press the "Light" button until the headlight and rear light turn on and the display icon  appears. To turn off the light, hold the "Light" button for at least 2 seconds until the  icon on the display disappears.

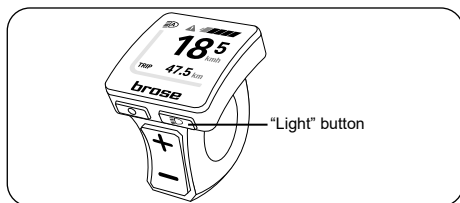

#### Light status

Lights not turned on



Lights turned on



automatic control activated

#### Activating the push assistance



The pushing aid function works to assist you if you have to climb a steep ramp from an underground car park or underpass, for instance. Do not use it to ride the bike. The push assistance can only be activated when stationary.



The push assistance is not a start-up support! If you activate your push assistance under a load that is too heavy, your motor will start to jerk or even perform an emergency shutdown.

Hold the “Push assistance” button until “Walk” appears on the display. Then press and hold the “-” button again to activate the push assistance. The engine supports you when pushing your Pedelec at a speed of up to 6 km/h (3.7 miles per hour). Deactivate the push assistance by releasing the “-” button.

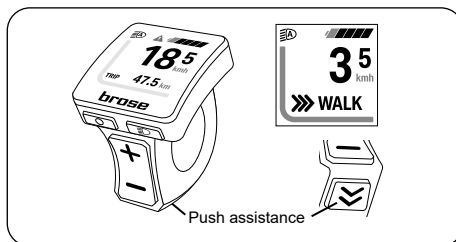

#### Trip information

Briefly press the “Menu” button to display the following trip information:

- Range
- Time
- Trip
- Travel time
- Average speed
- Maximum speed
- Total travel distance

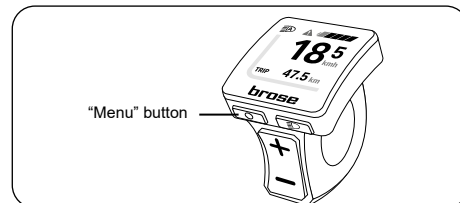

#### Battery charge indicator

The charge status of the battery is shown as a 5-segment icon on the display. Each segment corresponds to approximately 20 % battery capacity.

If the charge level of the battery is less than 10 %, the charge status indicator will begin to flash. If the charge level is less than 5 %, the final segment of the display will turn red. In this state, engine support will be switched off to ensure the lights can be used for a further 2 hours in case of an emergency.

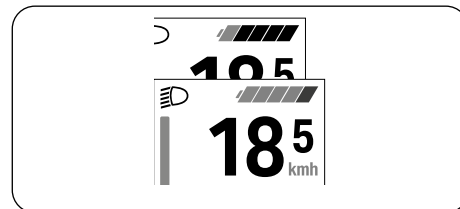

### Charge level indicator

white	Battery capacity > 10 %
red	Battery capacity ≤ 10 % (last segment red)

## Menu



The Menu cannot be accessed while cycling. The default language is English. You can change the language in "Settings" > "Languages".

To access the Menu, hold the "Menu" button for 2 seconds when the display is on. Use the "+" and "-" buttons to choose the option you want and select it with the "Menu" button.

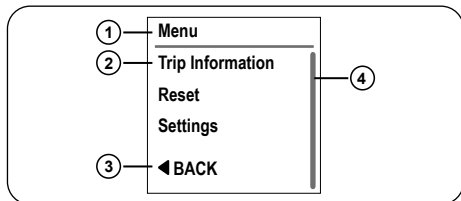

1. Heading (permanently visible)
2. Option
3. BACK (final list point, as an alternative to the "Push assistance" button)
4. Navigation bar

The "Menu" provides the following information:

- "Trip Information": Overview of all trip information
- "Reset": Reset all trip data
- "Settings"

### Reset trip information

Select "Reset" by pressing the "Menu" button. If you want to delete all trip information, confirm this by pressing the "Menu" button again. All trip data values will be set back to zero.

### Settings

Choose "Settings" in the menu to access the settings.

You can use the "+" and "-" buttons to access further options and open them with the "Menu" button. You can use the "Push assistance" button to leave the settings menu and go back to the main menu.

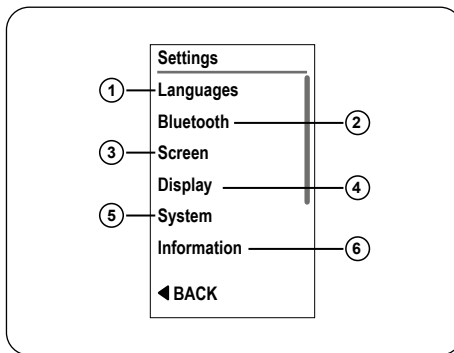

The following settings are available in the settings menu:

1. "Language": Choose a language to immediately change the display language.
2. To connect the display with the Fischer® e-Connect app, select "Connect smartphone" under Bluetooth. This will make the device visible enabling you to connect it.
3. "Screen": Customise the trip information shown during your trip. You can choose from:
  - Range
  - Trip (trip distance)
  - Time (travel time)
  - Average speed
  - Maximum speed
  - Total travel distance
4. "Display": Customise the colour and brightness of the display
  - "Automatic": automatic adjustment of display brightness, including day and night display ("white/black")
  - "Brightness": manual adjustment of display brightness control (can only be changed if the automatic control is disabled)
  - "White/Black": Switch between a white and black background
  - "Display off": The backlight of the display is switched off after 5 seconds of inactivity. All Pedelec and display functions remain active. Press any button to turn the backlight back on.

5. "System": see "System settings"
6. "Information": Displays information about the electrical system (product name & software version)

### System settings

Choose "System" in the menu. Use the "+" and "-" buttons to select the desired setting followed by the "Menu" button to open it. Do the same in the submenu if required. You can use the "Push assistance" button to go back to the previous menu from any submenu. You can also scroll down to "Back" at the bottom of the menu.

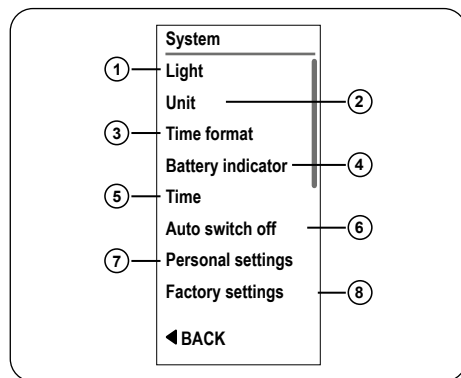

1. "Light":
  - Activate automatic bicycle lighting
  - Turn the bicycle lights on permanently
2. "Unit": (km/mi): Speed unit selection "(km/mi)" or "km/h/mph")

3. "Time format": Choose between a 12-hour and 24-hour display
4. "Battery indicator": Selection between:
  - Battery indicator as segments
  - Battery indicator as a percentage (%)
5. "Time": (hh : mm)  
Press the "Menu" button. The hour setting will start flashing. Use the "+" and "-" buttons to set the hours. Confirm your input with the "Menu" button.  
The minute setting will start flashing. Use the "+" and "-" buttons to set the minutes. Confirm your input with the "Menu" button. Press the "Push assistance" button to exit the menu.
6. "Auto Off": Set the automatic switch-off time (1-20 min)
7. "Pers. Settings": Tailor your support settings to your own needs.
8. Restore "Factory Settings": Select the "Factory Settings" menu item. Press the "Menu" button again to reset all settings to factory default.

### Error handling

Read the description of any Error codes carefully. If an error code appears, start by rebooting your system and then follow the troubleshooting steps below. Please contact our service hotline if you cannot resolve the problem yourself. Always quote the error code when contacting our service hotline

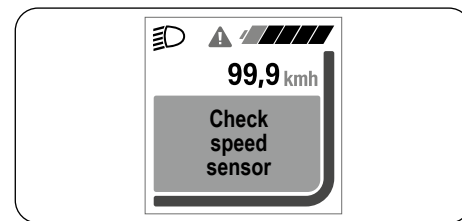

Error codes appear when the system automatically detects errors. Depending on the type of error, the engine may shutdown automatically. Check the Pedelec before riding. You can continue to cycle without assistance from the engine at any time.

Error message	Solution
Speed sensor fault	Check speed sensor and spoke magnet position
Light fault	Turn the system off completely. Check all cables and connectors in the front and/or rear light systems. Restart the system.
Internal system fault detected	Restart the system. If the problem persists, please contact an authorised e-bike retailer.
Brake light fault	Turn the system off completely. Check all cables and connectors in the brakes system. Restart the system.



Then check the points listed in the following table. In many cases, you can solve these problems yourself.

Symptom	Possible cause	Solution
The display unit and/or Brose Drive System cannot be activated.	Battery not properly inserted into its bracket.	If possible, remove the battery and reinsert it. Make sure it is inserted correctly.
	Battery not charged.	Fully charge the battery with the supplied battery charger.
	Dirty contacts on the battery and/or bracket.	Check that all contacts are clean. If necessary, clean them with a soft, dry cloth.
	Display unit not connected correctly.	Check the plug connection of the display unit. Make sure it is inserted correctly.
	Dirty contacts on the display unit and/or bracket.	Check that all contacts are clean. If necessary, clean them with a soft, dry cloth.
	Plug connectors not correctly plugged in to the drive unit.	Check the wiring and plug connections and connect them correctly if necessary.
Display unit does not provide trip data even though the e-bike is moving.	Spoke magnet not correctly mounted (distance to speed sensor).	Check whether the spoke magnet is mounted and check its distance from the speed sensor on the chain stay. It must be between 5 and 17 mm away (see figure B). Correct the distance if necessary.
Bicycle lights cannot be turned on.	Lighting cables incorrectly connected.	Check the wiring and plug connections and connect them correctly if necessary.

# Ananda D18 Display

## Display overview

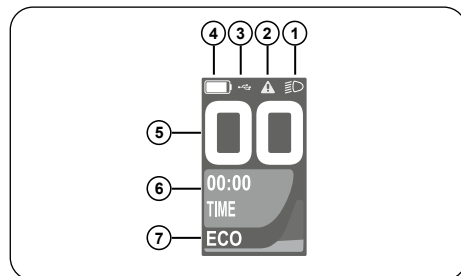

1. Lights
2. System information (e.g. errors)
3. Bluetooth
4. Battery charge level
5. Speed
6. Trip information
7. Current support level

## Operation

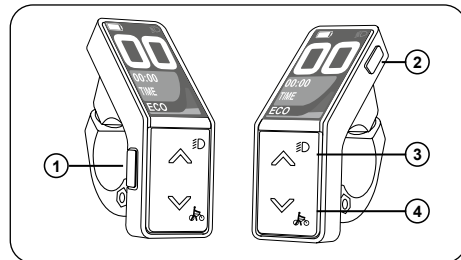

1. "i" button
2. On/Off button
3. "▲" button / light
4. "▼" button / push assistance

## Switch system on / off

Press and hold the On/Off button for 2 seconds to switch on the display.

Press and hold the on/off button for 2 seconds to switch the display off again.

## Support levels

Press the "▲" button to increase the level of motor support, or press the "▼" button to decrease it. There are support levels 0 - 5.

At level 0, you do not receive any motor support. The higher the level, the more the motor supports you. Level 5 gives you maximum motor power. However, it also consumes the most energy and you have the shortest range at this level.

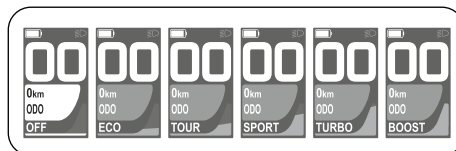

## Lights

Press and hold the "▲" button for 2 seconds to switch on the light. The light symbol appears on the display. Press and hold the "▲" button again for 2 seconds to switch off the light. The light symbol on the display turns off.



Light off

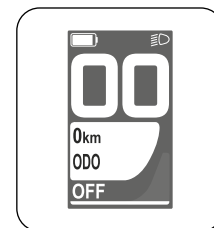

Light on

## Push assistance



The push assistance function can assist you if you have to climb a steep ramp or underpass, for example. Do not use it to ride the bike. The push assistance can only be activated when stationary.



The push assistance is not a start-up support. If you activate your push assistance when the pedelec load is too heavy, your motor will start to jerk and may even perform an emergency shut-down.

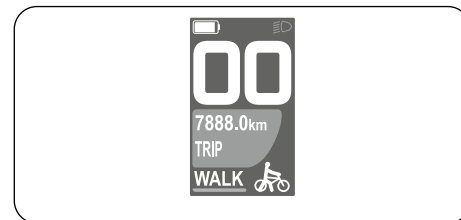

Press the “v” button in quick succession until the “WALK” assistance level is shown on the display. Then hold the “v” button for at least 2 seconds to activate the push assistance. The motor supports you when pushing your pedelec at a speed of up to 6 km/h (3.7 miles per hour). Deactivate the push assistance by releasing the “v” button.

### Trip information

You can switch between the following trip information by briefly pressing the “i” button:

ODO:	Total odometer reading
TRIP:	Daily distance
Time:	Travel time
AVG:	Average speed
MAX:	Max speed
M PWR:	Motor power
CONS:	Instantaneous power consumption of the motor in watts
C. INST:	Current power consumption of the motor in watt hours per kilometre
RANGE:	Remaining range
PD RPM:	Pedalling cadence

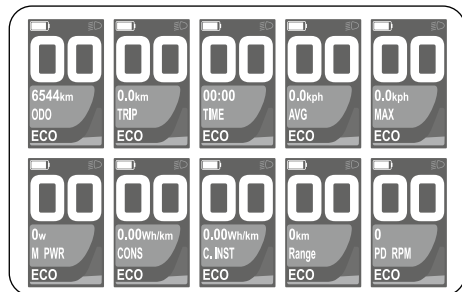

### Battery charge indicator

The charge status of the rechargeable battery is shown as a 5-segment icon on the display. Each segment corresponds to approximately 20% rechargeable battery capacity. If the charge level is low, the display starts to flash.



### Settings menu



Do not change the settings while riding your pedelec.

Press and hold the “i” button for 3 seconds to access the menu .

The menu includes the following options:

- ResetTrip
- Settings
- Information
- BACK

Navigate through the menu using the “v” or “^” button. Select menu items by briefly pressing the “i” button. Briefly press the power button to exit the menu and save the settings. Alternatively, you can exit the menu by selecting “BACK” and confirming with the “i” button.

### Reset trip distance

To delete the trip distance, travel time and average speed, select “ResetTrip” and then “Yes”. If you want to keep the data, select “No”. Then select “BACK” to return to the previous menu level.

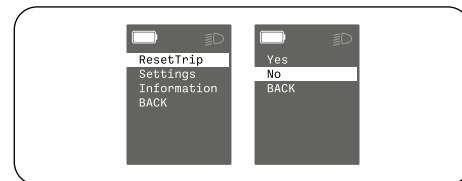

### Settings menu

Select “Settings” to access the Settings menu. The following menu items are displayed:

- Brightness
- Speed Unit
- Conso Unit (consumption unit)
- Language
- FactReset (factory reset)
- BLE (=Bluetooth)
- AutoOff (=automatic switch-off)
- Available functions (=select trip information)
- Max speed (= maximum speed)
- Power
- drvK (=motor control)
- Information
- BACK

### Brightness setting

Select the "Brightness" menu item to increase or decrease the brightness of the display.

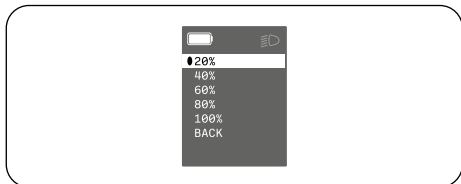

Select the desired brightness and exit the view via "BACK".

### Speed unit

Select the "Speed Unit" menu item to display the speed in km/h or mph.

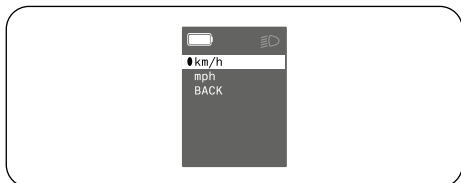

Select the desired speed unit and exit the view via "BACK".

### Consumption unit

Select the "Conso Unit" menu item to display the energy consumption in ampere hours per kilometre or watt hours per kilometre.

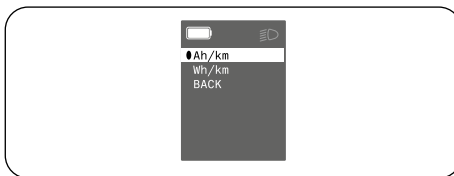

Select the desired unit and exit the view via "BACK".

### Language

Select the "Language" menu item.



Select English or French and exit the view via "BACK".

### Bluetooth

Select the 'BLE' option to open the Bluetooth menu.

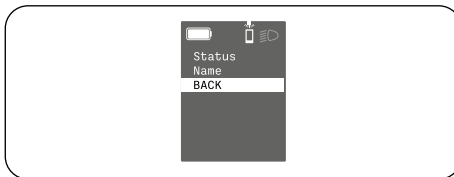

Select the "Status" menu item, then you can activate (enable) or deactivate (disable) Bluetooth. Exit the view via "BACK".

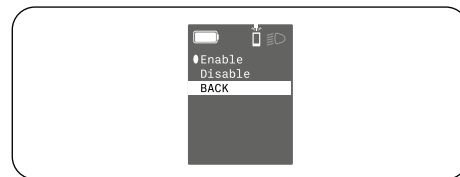

Select the menu item "Name" to view the Bluetooth name of your display. Exit the view via "BACK".

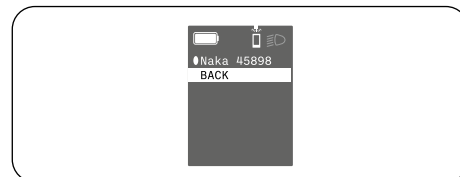

### Automatic switch-off

Select the "AutoOff" menu item.

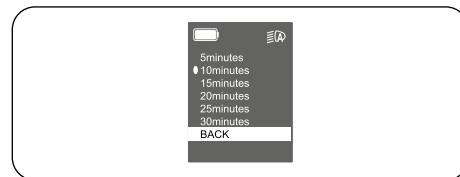

Select the desired time and exit the view via “BACK”. As soon as the set time has elapsed without activity, the pedelec’s electrical system switches off automatically. A newly set time only becomes effective after the display has been switched off and on again.

### Select trip information

Select the “AvailableFun” menu item to choose which trip information is shown on the display during the ride.

Mark the individual points by briefly pressing the “i” button to highlight them.

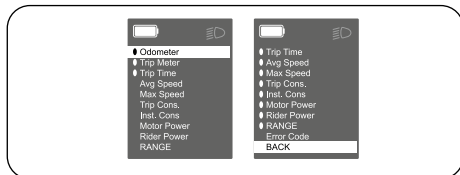

Exit the view via “BACK”.

### Maximum speed

Select “Max Speed” to set the maximum speed up to which the pedelec will assist you.

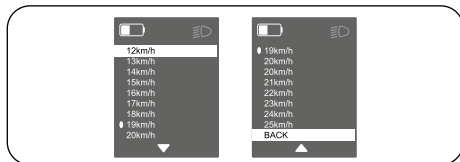

Select the desired speed by briefly pressing the “i” button.

Exit the view via “BACK”.

### Motor power

Select “Power” to adjust the motor power for the individual support levels.

Select a support level.

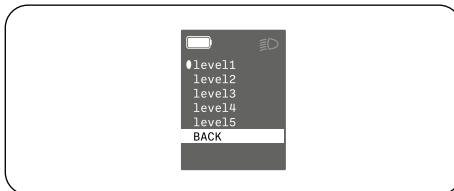

Choose a power between 100W and 700W.

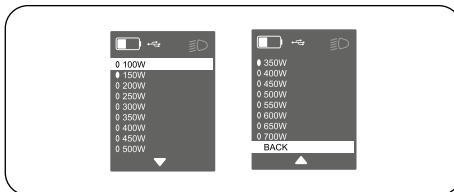

Exit the view via “BACK”.

### Motor control

Under “drvK” you can reduce the maximum power of the motor. This can help you to control the pedelec better. Select a support level.

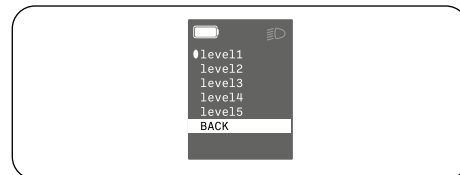

Select a value in the range from 0.1 to 1.0. The higher the value, the higher the maximum power of the motor. 0.1 is the weakest setting, 1.0 the strongest.



Exit the view via “BACK”.

### Information

Select “Information” to view details about the motor, rechargeable battery, display and IoT.

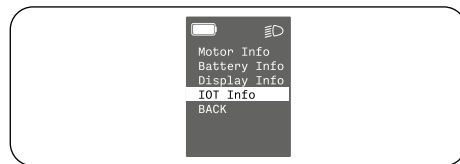

The “Motor” information contains details of the firmware version, hardware version, serial number, wheel diameter and total kilometres.

The “Battery” information contains details on the software version, hardware version, serial number, battery capacity, charging cycles and battery status.

The “Display” information provides details about the software version, hardware version, and serial number.

The “IoT” (Internet of Things) information contains details of the software version, hardware version and serial number, if this option has been used.

Exit the view via “BACK”.

### Error message

If there is a technical problem, a warning triangle and an error code appear on the display.



If an error code appears, start by rebooting your system and then follow the troubleshooting steps given in the table for the error code. Contact our service hotline if you cannot resolve the problem yourself. Always quote the error code when contacting our service hotline.

Error code	Description	Troubleshooting
01, 02, 09, 21, 22, 25, 26, 33	Voltage error	1. Restart the system or remove the rechargeable battery. 2. Replace the rechargeable battery. 3. If the problem persists, contact the Fischer Service.
03, 24	Torque signal, torque sensor has a fault.	1. Check that all connections are connected correctly. 2. If the fault continues to occur, contact Fischer Service.
05	The protective temperature inside the controller has reached the maximum safe value.	1. Switch off the system and let the pedelec cool down. 2. If the problem persists, contact the Fischer Service.
30, 08	Communication failed.	1. Check all connectors. 2. If the fault persists, contact Fischer-Service.

Error code	Description	Troubleshooting
06	The temperature inside the motor has reached the maximum safe value.	1. Switch off the system and let the pedelec cool down. 2. If the problem persists, contact the Fischer Service.
20, 31, 32	WALK and power button fault	1. Check whether the buttons are blocked. 2. If the fault continues to occur, contact Fischer Service.
04, 23	Brake signal has a fault	1. Check the brake cable. 2. If the fault continues to occur, contact Fischer Service.
28, 31, 31-50, 60	Technical error	Please contact the Fischer Service.

## Ananda D16 Display



### Control unit

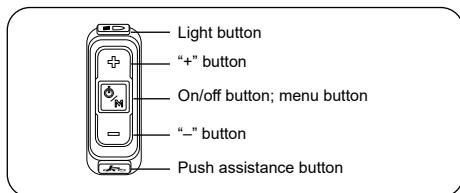

### Display overview

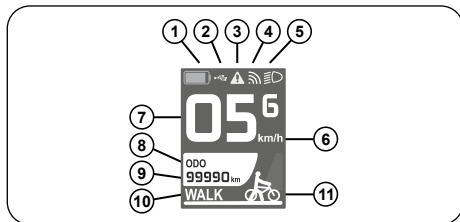

1. Battery charge level
2. USB charging active
3. Error messages
4. WLAN connection (WiFi)
5. Light in manual mode / light in automatic mode is displayed with the symbol
6. Speed unit
7. Current speed value
8. Trip information (here ODO odometer)
9. Value for trip information (here ODO odometer reading)
10. Support level (here push assistance)
11. Display for the push assistance

### Switching the display on/off

Press and hold the on/off button for 1 second to switch on the display.

Press and hold the on/off button for 2 seconds to switch the display off again. After 5 minutes of inactivity, the display automatically switches to sleep mode. After 30 minutes of inactivity, the electrical system switches off completely.

### Support levels

Press the "+" button to increase the level of motor support, or press the "-" button to decrease it. There are support levels 0-5.

At level 0, you do not receive any motor support. The higher the level, the more the motor supports you. Level 5 gives you maximum motor power. However, it also consumes the most energy and you have the shortest range at this level.

0 = OFF  
1 = ECO  
2 = TOUR

3 = SPORT  
4 = TURBO  
5 = BOOST

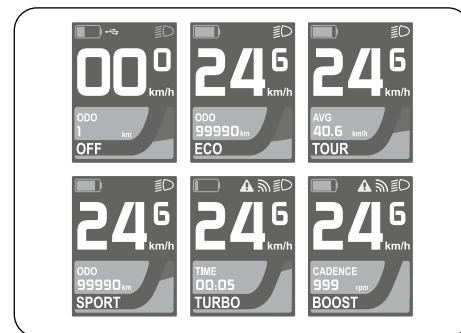

### Lights

Press the light button to switch the light on and off manually. When the light is switched on, the light symbol appears at the top left.

You can also activate an automatic mode in the settings. The light then switches on and off automatically depending on the ambient light. Automatic mode is indicated at the top left by a light with an A.

## Push assistance



The push assistance function can assist you if you have to climb a steep ramp or underpass, for example. Do not use it to ride the bike. The push assistance can only be activated when stationary.



The push assistance is not a start-up support. If you activate your push assistance when the pedelec load is too heavy, your motor will start to jerk and may even perform an emergency shut-down.

Press the “-” button several times until you reach the “WALK” assistance level. If you press and hold the push-assist button, the motor will support you at speeds of up to 6 km/h. The WALK symbol appears on the display.



Deactivate the push assistance by releasing the button.

## Trip information

By briefly pressing the On/Off button, you can switch between the following trip information:

ODO: Total distance  
TRIP: Daily distance  
TIME: Travel time  
AVG S: Average speed  
MAX S: Max speed  
M PWR: Motor power  
Range: Remaining range  
Cadence: Pedalling cadence

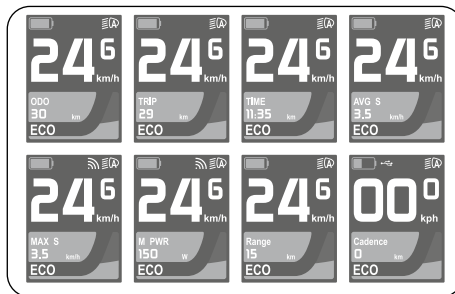

## Battery charge indicator

The charge status of the rechargeable battery is shown as a 5-segment icon on the display.



When the charge level is high, the display is green.



If the charge level is low, the display is red.

## USB charging

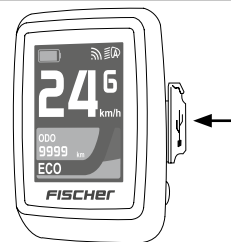

There is a USB charging socket on the display. The USB charging function can be switched on or off via the menu. Alternatively, the function can also be controlled directly using the “+” button. Press and hold the “+” button until the USB symbol appears on the display or disappears.





Only connect your electronic device to the USB charging socket when stationary! Inserting plugs and cables while riding can lead to falls and serious injuries.

### WLAN (Bluetooth)

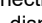
The display enables connections via Bluetooth. The WLAN symbol  is displayed when Bluetooth is activated. The function can be switched on or off via the menu.



### Settings menu



Do not change the settings while riding your pedelec.

Press the “+” and “-” buttons simultaneously to access the menu. The menu offers the following options:

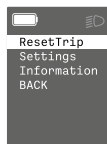

Navigate in the menu using the “+” and “-” buttons. Select menu items by briefly pressing the On/Off button.

Exit the menu level by selecting “BACK” and confirming with the On/Off button. Or press and hold the “+” and “-” buttons simultaneously to exit the menu.

### Reset trip distance

To delete the trip distance, travel time and average speed, select “ResetTrip” and then “Yes”. If you want to keep the data, select “No”.



Then select “BACK” to return to the previous menu level.

### Settings menu

Select “Settings” to access the Settings menu. The following menu items are displayed:

- Brightness (= Display brightness)
- Speed Unit
- Consumption unit
- Language
- Factory reset
- Bluetooth
- AutoOff (= automatic switch-off)
- USB charge enable
- Available functions (= select trip information)
- Max speed (= maximum speed)
- Power
- drvK (= motor control)
- Information
- BACK

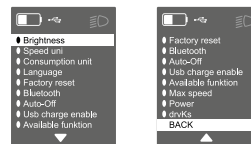

### Brightness setting

Select the “Brightness” menu item to increase or decrease the brightness of the display.

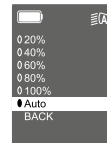

Select the desired brightness and exit the view via "BACK".

### Speed unit

Select the "Speed Unit" menu item to display the speed in km/h or mph.

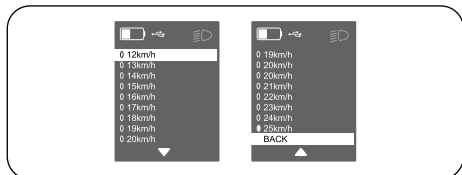

Select the desired speed unit and exit the view via "BACK".

### Consumption unit

Select the "Consumption Unit" menu item to display the energy consumption in ampere hours per kilometre and watt hours per kilometre.

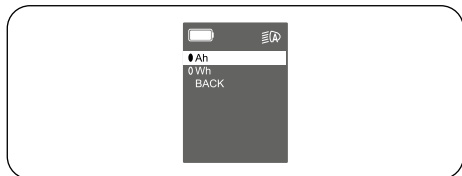

Select the desired unit and exit the view via "BACK".

### Language

Select the "Language" menu item.



Select English, French or German and exit the view via "BACK".

### Factory settings

Select the "Factory reset" menu item to restore the display to its factory settings.

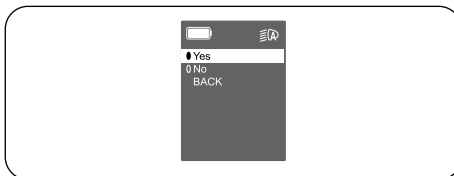

### Bluetooth

Select the "Bluetooth" menu item to open the Bluetooth menu.

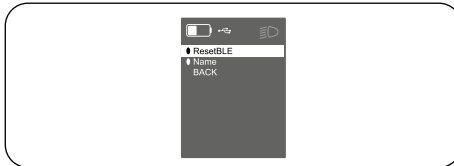

Select the "ResetBLE" menu item, then you can activate (enable) or deactivate (disable) Bluetooth. Exit the view via "BACK".

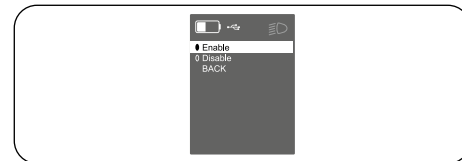

Select the menu item "Name" to view the Bluetooth name of your display. Exit the view via "BACK".

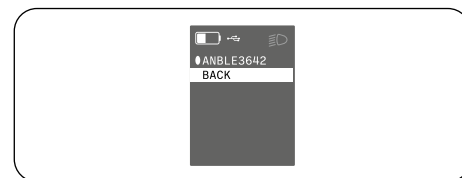

### Automatic switch-off

Select the "AutoOff" menu item.

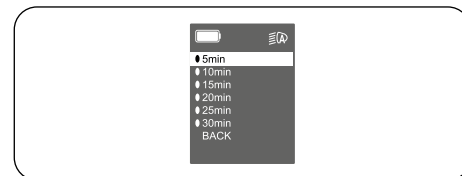

Select the desired time after which the system should switch off and exit the view via “BACK”.

As soon as the set time has elapsed without activity, the electrical system switches off automatically.

### USB charging

Select “USB charge enable” and then “Yes” to activate the charging function via the USB charging socket. Select “No” to switch it off.

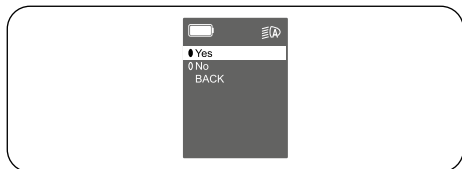

Then select “BACK” to return to the previous menu level.

### Select trip information

Select the “AvailableFun” menu item to choose which trip information is shown on the display during the ride.

Mark the individual points by briefly pressing the on/off button to highlight them.

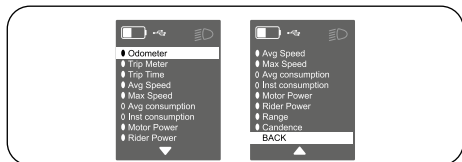

Exit the view via “BACK”.

### Maximum speed

Select “Max Speed” to set the maximum speed up to which the pedelec will assist you.

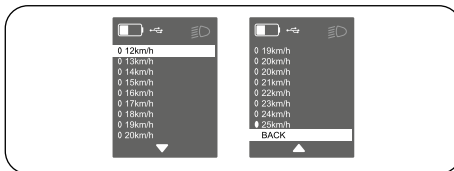

Select the desired speed by briefly pressing the On/Off button.

Exit the view via “BACK”.

### Motor power

Select “Power” to adjust the motor power for the individual support levels.

Select a support level.

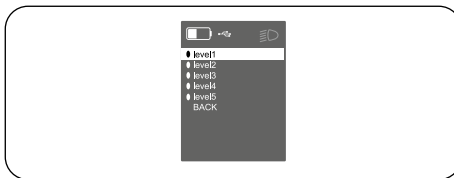

Choose a power between 100W and 700W.

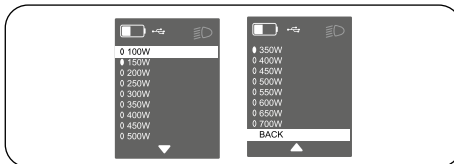

Exit the view via “BACK”.

### Motor control

Under “drvK” you can reduce the maximum power of the motor. This can help you to control the pedelec better. Select a support level.

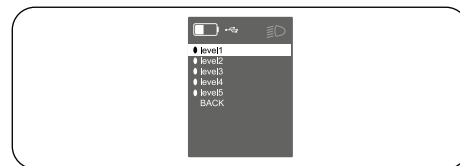

Select a value in the range from 0.1 to 1.0. The higher the value, the higher the maximum power of the motor. 0.1 is the weakest setting, 1.0 the strongest.

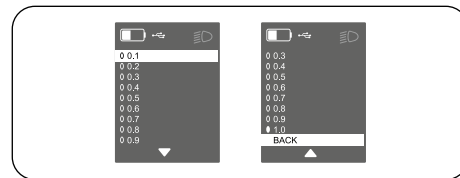

Exit the view via “BACK”.

### Information

Select “Information” to display information about the motor, rechargeable battery and display.

The “Motor” information contains details of the firmware version, hardware version, serial number, and total kilometres.

The “Battery” information contains details on the software version, hardware version, serial number, battery capacity, charging cycles and battery status.

The “Display” information provides details about the software version, hardware version, and serial number.

Exit the view via “BACK”.

### Error message

If there is a technical problem, a red warning triangle and an error code appear on the display.



Example error message



If an error code appears, start by rebooting your system and then follow the troubleshooting steps given in the table for the error code. Contact our service hotline if you cannot resolve the problem yourself. Always quote the error code when contacting our service hotline.

Error code	Description	Troubleshooting
09	Voltage error	1. Restart the system or remove the rechargeable battery. 2. Insert the rechargeable battery again. 3. If the problem persists, contact the Fischer Service.
36	Torque signal, torque sensor has a fault.	1. Check that all connections are connected correctly. 2. If the fault continues to occur, contact Fischer Service.
05	The protective temperature inside the controller has reached the maximum safe value.	1. Switch off the system and let the pedelec cool down. 2. If the problem persists, contact the Fischer Service.
30	Communication failed.	1. Check all connectors. 2. If the fault continues to occur, contact Fischer Service.

Error code	Description	Troubleshooting
06	The temperature inside the motor has reached the maximum safe value.	1. Switch off the system and let the pedelec cool down. 2. If the problem persists, contact the Fischer Service.
04	Brake signal has a fault	1. Check the brake cable. 2. If the fault continues to occur, contact Fischer Service.
28, 24, 21, 01, 02, 03, 50	Technical error	Please contact the Fischer Service.
26, 37	Speed signal of the torque sensor	1. Check that the speed sensor plug is connected correctly. 2. Check the wheel speed sensor for signs of damage. 3. If the problem persists, please contact the Fischer Service.

Error code	Description	Troubleshooting
25	has a fault.	<ol style="list-style-type: none"> <li>1. Check that all connections on the brake system are connected correctly.</li> <li>2. If the fault continues to occur, contact Fischer Service.</li> </ol>
26, 37	Speed signal of the torque sensor has a fault.	<ol style="list-style-type: none"> <li>1. Check that the speed sensor plug is connected correctly.</li> <li>2. Check the wheel speed sensor for signs of damage.</li> <li>3. If the problem persists, please contact the Fischer Service</li> </ol>

## FISCHER® e-Connect



With the FISCHER e-Connect app, you can link your pedelec to your smartphone to see all relevant driving data, routes, range and more clearly displayed on the screen.



Please note that the FISCHER e-Connect app is only compatible with the following displays: (displays from previous years are also listed) LED 550, LCD 900, LCD 1050, LCD 1300 from 2017, Allround, LCD 1400 and Comfort Control Panel. LCD 1350, LCD 1400, D16, D18 and Brose Display Allround.

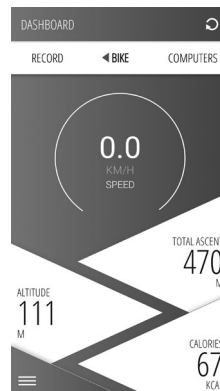
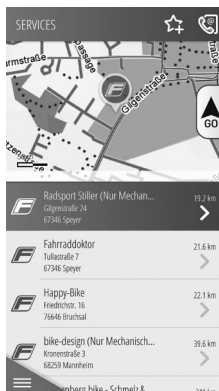

You must first make the Brose Display Allround visible to other devices before connecting it to the app for the first time. Go to "Bluetooth" in the display settings. Select "Connect smartphone". Then you can find the display.

## Functional overview

- Navigation in Europe - the maps of most European countries are available free of charge to use offline with the app
- View your pedelec's information and data in real time directly in the app
- The map takes into account topographic information, your current support mode and the charge status of your battery to show you how far you can drive from your current location.
- Record and save your journeys
- Export your favourite routes
- Easily import GPX data
- Display our service points in your area and navigate straight there if necessary
- Access our service department or our service hotline via the app
- Online maps powered by Google
- The content is available in multiple languages

## Download

The FISCHER e-Connect app is available for download in the Google Play Store and in the App Store.



App Store



Google Play Store

Scan the QR code to read more information on installing and using the e-Connect app.



## Transporting the pedelec



Remove the battery of your pedelec before transportation and transport it separately.

The battery is not considered a hazardous material when transported to operate the pedelec. The battery becomes a hazardous material when it is transported any other way. In this case, you must follow the appropriate guidelines.



Never send the battery yourself. Batteries are considered hazardous materials. In some circumstances, it can overheat and catch fire. Discuss the issue with your transport company. Your specialist/Fischer customer service technician can arrange transport as hazardous goods. Contact our service hotline.



### By car

You can transport your pedelec by car as you would a normal bicycle. Remove the battery before transport and transport it separately. The weight of the pedelec will call for a heavier-duty

rack. Always adjust your riding behavior to the load you are pulling in the carrier.



### On the train

The same regulations apply as when transporting a bicycle. Know which busses and trains you can take before using public transportation. It is best to remove the battery from the bike before and while using public transportation.

## Replacing parts on your pedelec

**Guidelines for the parts replacement of CE-marked e-bikes / pedelecs up to a pedal assist of 25 km/h (15.5 mph)**

### Category 1

Components which require the approval of the vehicle manufacturer/system provider before the replacement

- **Motor**
- **Sensors**
- **Electronic control unit**
- **Electric cables**
- **Operating unit on the handlebar**
- **Display**
- **Battery pack**
- **Charger**

### Category 2

Parts which must not be replaced without approval of the vehicle manufacturer

- **Frame**
- **Rear shock**

- **Rigid fork and suspension fork**
- **Wheel for hub motor**
- **Brake system**
- **Brake pads** (rim brakes)
- **Luggage carrier**  
(Luggage carriers directly affect the load distribution on the bicycle. Both negative and positive modifications will result in a riding behaviour potentially different from that intended by the manufacturer.)

### Category 3 \*

Parts which may be replaced upon approval of the vehicle or component manufacturer

- **Crank arm**  
(Provided that the distances crank arm – frame centre (Q-Factor) are observed)
- **Wheel without hub motor**  
(Provided that the ETRTO is observed)
- **Chain / Toothed belt**  
(Provided that the original width is observed)
- **Rim tape**  
(Rim tape and rims must be compatible. Modified combinations may result in rim tape shifting and thus in defective inner tubes)
- **Tyres**  
(The stronger acceleration, the additional weight and more dynamic cornering require the use of tyres approved for e-bike use. In this respect observance of the ETRTO is essential)
- **Brake cables / Brake hoses**
- **Brake pads**  
(Disc, roller, drum brakes)
- **Handlebar-stem unit**  
(Provided that there is no need to change the

lengths of cables and/or hoses. A modification of the seating position for the benefit of the consumer should be possible within the original cable lengths. A modification beyond results in a significantly changed load distribution on the bicycle and entails potentially critical steering properties)

- **Saddle and seat post unit**  
(Provided that the offset to the rear does not exceed 20 mm with regard to the series/original field of use. In this case, as well, a modified load distribution beyond the intended setting may possibly lead to critical steering properties. The length of the saddle rails at the saddle structure as well as the saddle form are also important.)
- **Headlights**  
(Headlights are designed for a specific voltage which must be compatible with the rechargeable battery of the vehicles. In addition, the electromagnetic compatibility (EMC) must be ensured whereas the headlight may be responsible for a part of the potential disturbance.)

\* An approval can only be given by the component manufacturer, if the component was tested sufficiently according to its intended use and the respective standards in advance and if a risk analysis was made.

### Category 4

Components which do not require a specific approval

- **Headset**
- **Bottom bracket**
- **Pedals**

(Provided that the pedal is not wider than the series/original pedal)

- **Front derailleur**
- **Rear derailleur**  
(All gear change parts must be suitable for the number of gears and be compatible with one another)
- **Shift levers / Twist grip**
- **Cables and housings**
- **Cranksets/pulley/cassette**  
(Provided that the number of teeth and the diameter is identical to the series/original area of application)
- **Chain guard**
- **Wheel protectors**  
(Provided that the width is not smaller than the series/original parts and the distance to the tyre is at least 10 mm)
- **Spokes**
- **Inner tube of the same type with the same valve**
- **Dynamo**
- **Rear light**
- **Reflector**
- **Spoke reflectors**
- **Kickstand**
- **Grips with screw clamps**
- **Bell**

### Category 5

Special notes for mounting accessories

- **Bar ends are permitted**
- **provided that they are mounted on the**

## front

(The load distribution must not be significantly changed)

- **Rear view mirrors are allowed.**
- **Additional battery/rechargeable battery-operated headlights are permitted in accordance with § 67 StVZO (Germany's Road Traffic Licensing Regulations).**
- **Trailers are only permitted after approval by the vehicle manufacturer.**
- **Child seats are only permitted after approval by the vehicle manufacturer.**
- **Front baskets are problematic, due to the undefined load distribution. Only permitted after approval by the vehicle manufacturer.**
- **Bicycle bags and top cases are permitted. Respect the maximum permissible weight, the maximum load of the rack and the load distribution.**
- **Attached weather protectors are only permitted after approval by the vehicle manufacturer.**
- **Front and rear luggage racks are only permitted after approval by the vehicle manufacturer.**

Source: [www.ziv-zweirad.de](http://www.ziv-zweirad.de), updated on May 08, 2018

## Environment protection tips/ Disposal

General cleaning and maintenance: Remember the environment when maintaining and cleaning your pedelec. You should use care and cleaning products which are biodegradable wherever possible. Please make sure that no cleaning agents are disposed of in the sewage.

### Pedelec batteries

Batteries belonging to pedelecs should be treated as hazardous and are therefore subject to compulsory special labelling.

Please contact our service hotline about how to dispose of your battery.

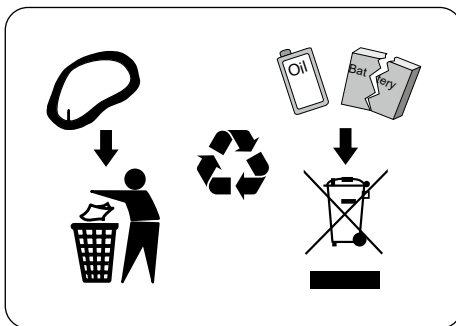



## Technical characteristics

### Battery

	36 V battery	48 V battery
Rated voltage	36V/36,3V	46,8V–48V
Rate Capacity	418–711 Wh	418–688 Wh
Nominal Capacity	8,8–19,6Ah	8,7–14,7Ah
Charging time	4,5–6,5 h	4,5–7 h
Storage	-10 to 35°C	-10 to 35°C
Maximum charging cycles	1000	1000

### Charger

Operating voltage	220 V
Output current	2A and 3A

### Motors

	Central motor Bafang M 200	Central motor (Brose Drive C ALU)	Central motor (Brose Drive T ALU)	Central motor (Brose Drive S ALU)	Central motor Bafang M 400	Hub motor Bafang Silent Drive	Hub motor FISCHER Silent Drive
Operating voltage (DCV)	36	36	36	36	36–48	36–48	36–48
Rated power (W)	250	250	250	250	250	250	250
Maximum torque (Nm)	65	50	70	90	80	32–45	40–50

## Warranty



The conditions for guarantee / liability for faults are (partially) harmonised in countries that are subject to EU law. Find out about the relevant national stipulations that apply to you.

Within the scope of EU law, the seller is liable for material faults for at least the first two years from the date of purchase. This includes defects that were present at the time of purchase or handing over. Moreover, during the first six months it is assumed that the fault already existed at the time of purchase.

Bicycles – especially those with auxiliary electrical motors – are complex vehicles. Therefore it is required to implement all service intervals properly. Omitting servicing puts the claim of the seller at risk if the error could have been avoided by servicing. The necessary maintenance is outlined in the chapters of these operating instructions and in the enclosed instructions from the component manufacturers.

In the event of damage associated with this, any warranty claims are void if you remove or fail to replace missing seals and/or covers (e.g. on charging plugs or ports).



Contact our service hotline in the event of a defect/liability claim. We recommend filing all purchase receipts and inspection reports as proof for your records.

## Guarantees

FISCHER – the bicycle brand® grants you, besides the warranty required by law that are not affected hereby, an additional

### MANUFACTURER'S GUARANTEE:

#### General

MTS Group Inter-Union Technohandel GmbH, Carl-Benz-Strasse 2, 76761 Rülzheim grants you a 24-month guarantee for the battery and a 10-year guarantee for a frame break. Any age- and charge cycle-related degeneration of the battery, and thus the battery capacity, is excluded from the scope of the guarantee. Regardless of this warranty, you are entitled without restriction to your statutory rights as a consumer. Your guarantee rights according to Section 437 BGB (German Civil Code) – i.e. the right to rectification, withdrawal or reduction and compensation – are not affected by this manufacturer's guarantee.

### Duration of the guarantee

The guarantee granted by MTS Group Inter-Union Technohandel GmbH concerns guarantees with a duration of 24 months for the battery and 10 years for a frame break. A guarantee of one year is applied to B-products, which can only be purchased in factory sales. The guarantee begins at the time of delivery of the good to you or a third party named by you, who is not the carrier.

### Guarantee scope

The guarantee applies in the event of manufacturing or material defects.

### Guarantee terms and conditions

This guarantee is granted exclusively to private individuals, who have bought the FISCHER e-bike themselves from FISCHER trade partners, who exclusively use it for intended, private use outside of competitions and register with us online within 6 weeks of the purchase date.\* Evidence of an initial inspection must be provided. Please retain the purchase receipt for your records at least for the duration of the guarantee.

\* Registration is possible at [www.fischer-fahrrad.de](http://www.fischer-fahrrad.de). In order to complete the form, your personal data as well as the data of your bicycle logbook (contained in the operating manual) and the purchase receipt are required.

**The guarantee excludes:**

Damages that are caused by technical modifications, improper repairs or defective maintenance according to the operating manual. Further detailed guarantee exceptions can be found in the operating manual. We are obliged to provide evidence with regard to the aforementioned exceptions.

**Applicable law**

German law is applicable for claims arising from the guarantee.

**Warranty terms and conditions (extract):**

- Exclusively for private end consumers who have bought the FISCHER e-bike from a FISCHER-approved FISCHER trade partner (evidence in the form of a purchase receipt required)

- Only for intended use for private purposes; i.e. especially no use for competitions or renting
- Online registration within 6 weeks of the purchase date at [www.fischer-fahrrad.de](http://www.fischer-fahrrad.de)
- No guarantee for damages that are caused by technical modifications, improper repairs or defective maintenance. Information on proper maintenance can be found in the operating manual you received together with your FISCHER e-bike.
- In cases covered by warranty, we will replace or repair the defective part.
- The extensive guarantee conditions can be found at [www.fischer-fahrrad-kundendienst.de](http://www.fischer-fahrrad-kundendienst.de)

The law of the Federal Republic of Germany applies.

## Services

You receive a comprehensive offer of additional services when purchasing a FISCHER pedelec.

**Service hotline**

You can reach our free service hotline by calling +49 721 97902560 from Germany, +43 1 9073366 from Austria, +48 22 738 64 60 from Poland, +800 3279 7834 from Croatia/Denmark or +800 01 01 01 from the Czech Republic.

Or by visiting the following website:  
[www.fischer-fahrrad-kundendienst.de](http://www.fischer-fahrrad-kundendienst.de)

Please keep the following information at hand when calling the hotline:

1. Year of manufacture
  2. Model (e.g. ECU 1820 or EM 1864)
  3. Article no. (E.g. 18005 or 18024)
- One place you can find this information is on the serial plate.

In addition, we will need your contact details for further processing.

## After Sales Service

### Service in Germany and Austria:

Für Fragen zu Ihrem Pedelec nutzen Sie bitte die Fischer Community unter <https://community.fischer-fahrrad.de/customers/s>, schreiben uns eine E-Mail an **support@fischer-fahrrad-kundendienst.de** oder Sie wenden sich an unsere Service Hotline in Deutschland **+49 721 97902560** oder unsere Service Hotline in Österreich **+43 1 9073366**.

### Service in the Netherlands and Belgium:

Je hebt een probleem ontdekt met je e-bike? FSN+, als partner van FISCHER, staat hier aan uw zijde!

Registreer uw fiets/e-bike op de website van FSN+ en ervaar zorgeloze fietstochten met het volledige ser-vicepakket! U kunt ook telefonisch contact met ons opnemen op het volgende telefoonnummer: **+800-32797834**

**Fischer-Service-NL@mts-gruppe.com**

Vous avez rencontré un problème avec votre VAE? FSN+, en tant que partenaire de FISCHER, est à vos côtés !

Enregistrez votre VAE sur le site web de FSN+ et faites l'expérience de tours à vélo sans soucis grâce au pack de services complet ! Vous pouvez également nous contacter par téléphone au numéro suivant : **+800-32797834**

**Fischer-Service-BE@mts-gruppe.com**

### All other countries:

**EN** Dear customer, if you have any questions or problems with your FISCHER e-bike, please first contact the company/store where you purchased the FISCHER e-bike directly. There you will get an answer.

**FR** Cher client, si vous avez des questions ou des problèmes avec votre VAE FISCHER, veuillez d'abord contacter directement la société/succursale où vous avez acheté le VAE FISCHER. Vous y obtiendrez une réponse. Ou écrivez à l'adresse électronique suivante **Fischer-Service-F@mts-gruppe.com**

**ES** Estimado cliente, si tiene alguna pregunta o problema con su FISCHER E-Bike, por favor contacte primero con la compañía/sucursal donde compró la FISCHER E-Bike directamente, allí obtendrá una respuesta. También puede escribir a la siguiente dirección de correo electrónico: **Fischer-Service-E@mts-gruppe.com**

**CZ** Vážení zákazníci, pokud máte jakékoli dotazy nebo problémy s elektrokolem FISCHER, obraťte se nejprve přímo na společnost/obchod, v němž jste elektrokolo FISCHER zakoupili.

Nebo se obraťte na: **servis@kolofix.cz**

**+800 01 01 01**.

Servis vám odpoví.

**PL** Drogi Kliencie, w przypadku pytań lub problemów z rowerem elektrycznym FISCHER, najpierw skontaktuj się bezpośrednio z firmą/ sklepem, w którym dokonałeś zakupu roweru elektrycznego FISCHER.

Alternatywnie, skontaktuj się z nami drogą mailową: **serwis@fischer-ebike.pl**, **+48 22 738 64 60**

Tam uzyskasz pomoc.

**PT** Caro cliente, se tiver quaisquer perguntas ou problemas com a sua e-bike FISCHER, por favor contacte primeiro a empresa/loja onde adquiriu directamente a e-bike FISCHER. Ai obterá uma resposta.

**FI** Hyvä asiakas, jos sinulla on kysymyksiä tai ongelmia FISCHER-sähköpyöräsi kanssa, ota ensin yhteyttä yritykseen/myymälään, josta ostit FISCHER-e-pyörän suoraan. Siellä saat vastauksen.

**SE** Kära kund, om du har några frågor eller problem med din FISCHER e-cykel, vänligen kontakta först företaget / butiken där du köpte FISCHER e-cykel direkt. Där får du ett svar.

**HR** Servis vám odpoví. Poštovana korisnice, poštovani korisnici, ako imate pitanja ili problema s vašim FISCHER električnim biciklom, molimo vas da se prvo izravno obratite tvrtki/dućanu od kojeg ste kupili vaš FISCHER električni bicikl. Alternativno, možete nas kontaktirati na +800-32797834.

**DK** Kære kunde, hvis du har spørgsmål eller problemer med din FISCHER elcykel, bedes du først

kontakte det firma/den butik, hvor du har købt din FISCHER elcykel direkte. Alternativt kan du også kontakte os på +800-32797834.



MTS Group  
Inter-Union Technohandel GmbH  
Carl-Benz-Straße 2  
76761 Rülzheim  
Germany

No liability is assumed for typesetting and printing errors  
Copyright | Last updated: 04/2025

#### Service hotline

Germany	+49 721 97902560
Austria	+43 1 9073366
Poland	+48 22 738 64 60
Czech Republic	+800 01 01 01
Croatia/Denmark	+800 3279 7834