

# **FISCHER**

*die fahrradmarke*

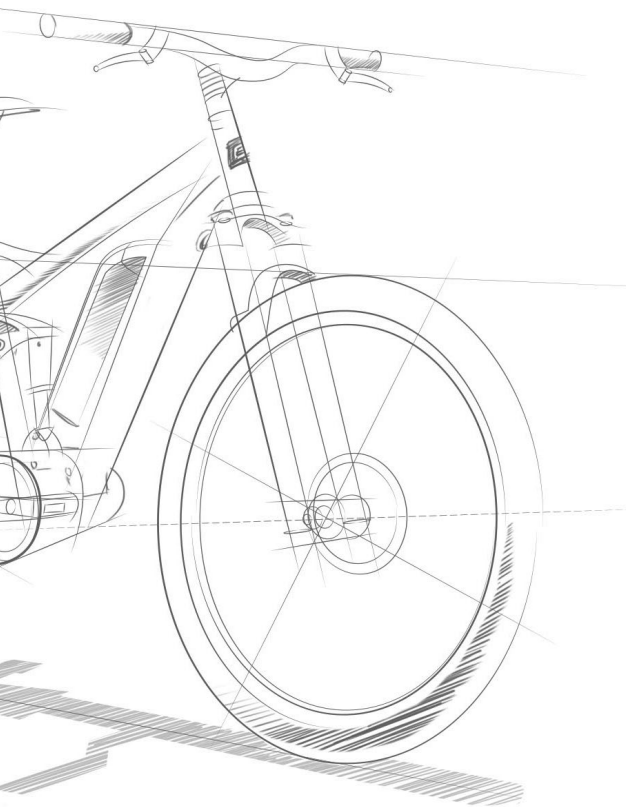

EN

## **ASSEMBLY AND QUICK START GUIDE**

**ORIGINAL OPERATING INSTRUCTIONS PEDELEC 2026**

# Contents

<b>Contents</b>	2	<b>Adjusting the seat</b>	12
<b>Legal disclosure</b>	2	Correct seat height	12
<b>Introduction</b>	3	Saddle tilt	13
<b>Safety Instructions</b>	4	Handle bar position / Stem	13
<b>Intended Use</b>	5	Suspension	13
Classification: Category 1	6	<b>Instructions about electrics and electronics</b>	14
Classification: Category 2	6	Charging process	14
Classification: Category 3	6	Charger	14
<b>Legal Regulations</b>	6	Maintenance and care	14
<b>Children</b>	6	<b>Before the first ride</b>	14
Children and pedelecs	6	<b>Mechanical components</b>	16
Carrying children/trailers for children	7	Back pedal brakes	16
<b>Unpacking</b>	7	Chain	16
<b>Assembly</b>	8	Brakes	16
Using quick release levers and quick	8	Gear change system	17
release axles	8	<b>Loose/mounted accessories</b>	17
Handlebars with a quill stem	9	Luggage rack	17
Handlebars with an A-head stem	10	<b>EC- Declaration of Conformity</b>	18
Handlebars with a Stem Twist	10	<b>EC- Declaration of Conformity</b>	19
Pedals	11	<b>After Sales Service</b>	20
Brake levers	11	Service in Germany and Austria:	20
		Service in the Netherlands and Belgium:	20
		All other countries:	20

## Legal disclosure

Fischer Quickstart Assembly Version 6.0  
July 2025

MTS Group, Inter-Union Technohandel GmbH,  
Carls-Benz-Straße 2, 76761 Rülzheim, Tel:  
+49 7272 9801-100, Fax: +49 7272 9801-  
123, [www.mts-gruppe.com](http://www.mts-gruppe.com)

MTS Group Inter-Union Technohandel  
GmbH is represented by: Managing director:  
Daniel Lück, Ralf Reuwer und Frank Jansen

The declaration of conformity for Fischer  
pedelecs can also be found on the Internet at  
[www.fischer-fahrrad.de](http://www.fischer-fahrrad.de)

Responsible for distributing and marketing  
the operating instructions: inMotion mar.com  
[info@inmotionmar.com](mailto:info@inmotionmar.com), [www.inmotionmar.com](http://www.inmotionmar.com)

Contents and illustrations: Veidt-Anleitungen  
[info@veidt-anleitungen.de](mailto:info@veidt-anleitungen.de)

These operating instructions cover the  
requirements and scope of application of EU  
law. If this product is delivered or used outside  
the aforementioned area, the bicycle manu-  
facturer must provide the necessary operating  
instructions. Subject to modifications. Last  
updated at publication 07/2025

© Before reproducing, reprinting, translating  
or using this document for any commercial  
purpose (even in part, printed or electronic  
form), you must first receive written consent.

If you have any questions about your pedelec, please contact our service hotline for Germany (+49 721 97902560),  
for Austria (+43 1 9073366), for Poland (+48 22 738 64 60) for Croatia/Denmark (+800 3279 7834) or for the Czech  
Republic (+800 01 01 01).

Printing and typographical errors reserved  
Copyright | as of 07/2025 | article no: 802805

## Introduction

Your pedelec has been carefully pre-assembled in the factory. For easier transport, some parts have been loosened and put in transport position. For the pedelec to be ready and safe to ride, these parts must be moved back into a normal position and secured after unpacking. Be sure to read and follow the assembly and quick start guide carefully, keep it in a safe place and follow all the steps described in it.

The assembly and quick start guide contains summarized information and is only valid in con-



junction with the complete original operating instructions and system manual. These instructions are available for you online. Scan the QR code or go to <https://service.fischer-bike.com/downloads>

If page numbers are given, they refer to the pages of the original operating instructions.

If you do not have internet access, we will send you a hard copy of the original operating instructions and system manual free of charge. Please contact our service hotline (Germany: +49 721 97902560, Austria: +43 1 9073366, Poland: +48 22 738 64 60, Czech Republic: +800 01 01 01). Read all instructions carefully before your first ride and follow all steps. We recommend keeping these manuals near your pedelec so that they are always at hand. If you lend your pedelec to a third party, please give them these manuals

along with the pedelec.

You may use the pedelec if:

- You have fully read, understood and implemented the original operating instructions and system manual in their entirety.
- You have basic knowledge of how to use pedelecs.

Check immediately that your pedelec is complete and undamaged. Contact Fischer Service if this is not the case. To ensure that it is in safe operating condition, all assembly and adjustment work needs to be completed first.

For any major or safety-related work, contact our service hotline and leave this work to a specialist/Fischer service technician.

This guide applies to the model indicated on the package in which it came (E-CITY/E-TREKKING/E-MTB).

You will also find a wide range of information and videos about use, maintenance and settings online.



<https://service.fischer-bike.com/downloads>



[www.youtube.com/user/FischerFahrradmarke](https://www.youtube.com/user/FischerFahrradmarke)

### ***Note for parents and legal guardians:***

As your child's legal guardian, you are responsible for their actions and safety. This includes responsibility for the pedelec's technical condition and adjusting it to the rider.

You must also ensure that your child has learned how to use the pedelec safely. Make sure your child has learned and understood how to use their pedelec safely and responsibly in the environment in which they will be riding.

## Safety Instructions

First, a few pointers which the person using the pedelec should consider before starting a journey:

- Always wear a fitted and suitable bicycle/pedelec helmet and use it each time you ride.
- Any time you ride, always wear bright clothing or sports clothes with reflective elements. This is vital so that other people can see you.
- Tight clothing is mandatory; if you do not have any, use trouser clips. Your shoes should be slip-resistant and have hard soles.
- Never ride with headphones. Never use your phone while riding.
- Never cycle if you are unable to control your bike completely. Under no circumstances should you cycle if you have taken medicine or are under the influence of alcohol or drugs.
- Never ride with your hands off the handlebars!
- Ride at an appropriate speed for the terrain and your riding capabilities.
- Under wet and slippery conditions, adapt how you cycle accordingly. In this case, you should ride more slowly and brake earlier and more gradually, as the braking distance becomes significantly longer.
- Pay particular attention to others on the road.



**Before your first ride, please be sure to read the chapters “Before the first ride” and “Intended use”!**

This operating manual contains five different types of pointers – one providing important information about your new pedelec and how to use it, a second referring to possible damage to property and the environment, and a third type warning against potential falls and serious damage, including physical injury. The fourth pointer helps you to apply the proper torque so the parts don't loosen or break. The fifth pointer reminds you that you need to study the operating, system and assembly instructions carefully.

When you see these symbols, there is always a risk that the described danger may occur. The text which the warning covers always has a grey background.

The warnings break down as follows:



### Note

This symbol provides information about how to use the product or highlights specific parts of the operating instructions that are particularly important.



### Attention

This symbol warns of misuse which could result in damaging the product or the environment.



### Danger

This symbol indicates possible dangers to your health and life that could arise if specific actions or appropriate care is not taken.



### Important bolted connection

Precise torque must be applied here when tightening. To find out the correct tightening torque, you can either look on the bike part itself or in the table listing the tightening torque values which is found in the original operating instructions. In order to apply a precise torque, you must use a torque wrench. If you don't have a torque wrench, please contact an expert/ Fischer customer service technician. Parts which do not have the correct torque could fall off or break! This may result in severe falls.



### Operating instructions

Read and follow all instructions supplied with the bicycle, instructions on the website <https://service.fischer-bike.com/downloads> and instructions on the manufacturer's websites. If you are in doubt about any topic in this manual, please contact our service hotline.

## Intended Use



Pedelecs are means of transport designed to be ridden by one person. Transporting an additional person on the pedelec is only permitted in the framework of national legislation. If you would like to transport baggage, your pedelec needs to be fitted with suitable equipment. Children may be transported in suitable child seats or in trailers intended for this purpose. Pay attention to quality. Ensure that you do not exceed the maximum permissible weight.



Protect your pedelec from unauthorized and improper use by others. Never leave your pedelec unattended and always secure it with a lock. Always take your lock with you to secure your pedelec.

Unless otherwise specified, trailers and additional luggage racks are not permitted. The pedelec is not licensed for competitions. Child seats must be attached to the frame.

Fischer pedelecs with a Brose motor and without rear suspension are approved for use with trailers. Fischer models manufactured in or after 2023 with a fully integrated battery are approved for use with trailers.

For information on trailer use with other models, please contact the FISCHER service hotline on +49 721 97902560 or send an e-mail to [support@fischer-fahrrad-kundendienst.de](mailto:support@fischer-fahrrad-kundendienst.de).

Child seats are only permitted on pedelecs without rear suspension.



Not every pedelec can be used everywhere and for every purpose. Before riding for the first time, be sure to read the information in the "Intended use" section of the original operating instructions. You can find this section on pages 14–16. If you are not clear about what type of pedelec you have and how it should be used, contact us via our service hotline.

The manufacturer and retailer shall not be liable for use that falls beyond the scope of intended use. This applies particularly to damage resulting

from failure to comply with the safety instructions, e.g., owing to

- use on terrain,
- overloading, or
- the improper repair of defects.

Pedelecs are not intended for hard impact, extreme use (i.e. riding over steps, jumps) and extreme sporting events (i.e. bike tricks, stunt jumping). Participation in competitions is only allowed when authorised by the manufacturer.

You can find out which of the following types your pedelec belongs to by checking the sticker on the seat tube.

This sticker may not be in your language.

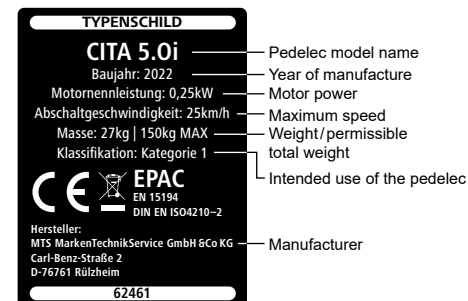

The following information describes the proper use of pedelecs that have been equipped as prescribed by national legislation:

### Classification: Category 1

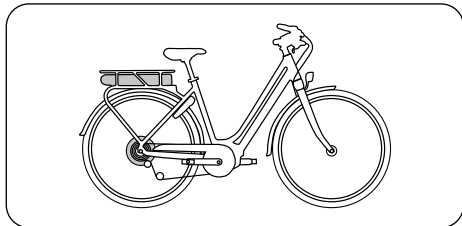

Refers to pedelecs used on normal paved surfaces where the tyres are intended to maintain ground contact at average speeds and to handle occasional drops or jumps/steps. Drops, jumps or steps must not be higher than 15 cm. Typical average speed is 15 to 25 km/h.

### Classification: Category 2

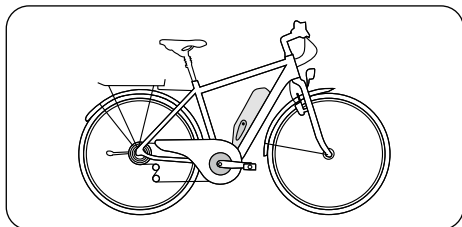

Refers to pedelecs to which condition 1 applies and which are also used on unpaved roads and gravel paths with moderate uphill and downhill gradients. In these conditions, there may be

contact with uneven terrain and repeated loss of contact between the tyre and the ground. Drops, jumps or steps must not be higher than 15 cm. Typical average speed is 15 to 25 km/h.

### Classification: Category 3

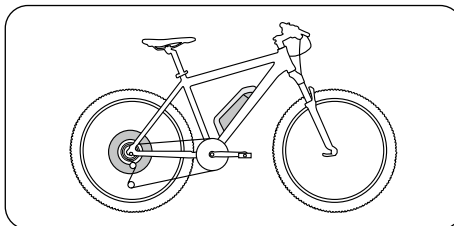

Refers to pedelecs to which condition 1 and condition 2 apply which are also used on rough paths, rough unmade roads, difficult terrain and on unmade paths and which require technical skill to use. The height of jumps, drops or steps should be less than 60cm. You should always wear the appropriate safety equipment (eg. a suitable helmet and cycling gloves).

## Legal Regulations



Find out about the relevant national stipulations that apply to you.

According to EU law, a pedelec is under the same category as a bicycle and, therefore, has the same requirements.

Discussions on the obligation to wear helmets are ongoing. Before setting out on a ride, find out about the legal stipulations that apply to you.

## Children

### Children and pedelecs

Inform yourself on whether the child is old enough to ride the bike and has the necessary license to do so before allowing him or her to ride the pedelec. Pedelecs may only be ridden by children that are of legal age and possess the necessary permit. Children under 16 should not ride a pedelec.



Don't let children who are unattended ride the pedelec without first thoroughly instructing them on how to use it. Explain to children the dangers of using electrical devices.

## Carrying children/trailers for children



Child seats may only be used when they are mounted on the seat tube. Child seats **MUST NOT** be mounted on the luggage rack.

- Please only use safe, certified children's seats.
- The child must wear a helmet, their feet must be tucked in and protected from any possible contact with moving parts, such as spokes.
- A child seat changes the way your pedelec behaves when riding. Take note of the longer braking distances and the steering which could be less stable. Practice riding with a child seat in a safe area before taking to public roads.



Please comply with the manufacturer's instructions supplied with the seat.



In some countries, only children up to a certain age may ride in child seats. Find out about the legal regulations which relate to the age of the child and the rider.



If a child trailer is being towed and a quick release is used on the rear wheel, the axle of the quick release must be long enough to securely fasten the trailer.



Check whether the trailer manufacturer specifies a maximum load and a maximum permitted speed (e.g., 16 km/h). These values must then be adhered to. Children under 16 are not legally permitted to ride a bike with a trailer in Germany.



Full suspension pedelecs are not suitable for use with trailers and child bike trailers! The bearings and attachments are not designed to withstand this sort of force. This could result in wear and damage with serious consequences.



The carton may be heavy.

See if there are any markings on the box (e.g., arrows or "ABOVE"). Place the box according to these markings. It must be placed on its underside. Then open it from one of the narrow sides and take the pedelec out of the carton.

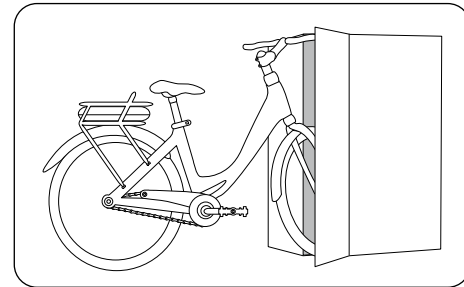

Be careful; metal staples may have been used to close the carton. Take care not to injure yourself on these staples.

## Unpacking

The Pedelec is shipped in a special closed shipping carton. Find a suitable space for performing the assembly.

In the shipping box, you will also find an accessory box containing the pedals, power adapter for charging the battery, and the assembly and quick start guide. You will also find the necessary tools for assembly (except for a torque wrench) in the box. The included tool is not suitable for first assembly. It is intended for use for makeshift repairs on the road!

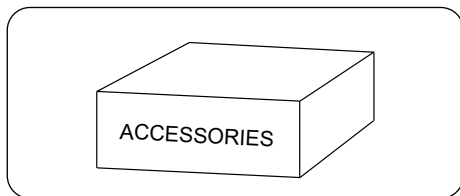

Remove the protective packaging material and cable ties with pliers or scissors.



Dispose of the packaging material properly and according to regulations at an appropriate disposal site. The shipping packaging for this product must not be disposed of with household waste (e.g., yellow bag, blue garbage can, etc.). Instead, you can return it to us free of charge. The aim of offering this alternative option to return the used packaging is to ensure that it is collected separately from household waste so that it can be properly recycled or reused. Please note that you may need the shipping packaging if you wish to return the pedelec. Please contact our service hotline.

## Assembly



Be sure to check that all screw connections and fasteners are securely fixed after assembly and adjustments are complete.

The vehicle has had lubricants applied at various locations. Always wear appropriate clothing and personal protective equipment, such as suitable gloves, when assembling.



Wear suitable protective clothing, protective gloves and protective goggles during all installation and maintenance work. Otherwise, dirt or injuries that may be caused by lubricants and auxiliary devices for the motor among other things may result.

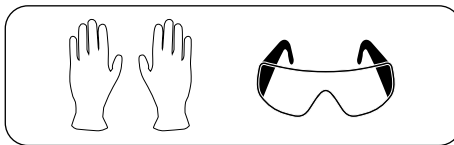

## Using quick release levers and quick release axles

Quick release levers and axles are systems installed on the pedelec in place of bolted connections. They consist of two parts: the quick release lever, which provides the necessary clamping force, and the adjustment nut, which allows you to regulate the tightness. You can change the tightness of your quick release when it is open.



Quick releases should be closed with the correct tightness. To close the lever correctly, pressure should be felt when it is half closed and, at the end, the ball of the thumb needs to be used to completely close it. On current chassis, quick release axles may be used in place of quick release levers or bolts. These usually function like quick release levers and must be operated as such. The axle is attached or screwed into the dropout and holds the hub between the two dropouts. The hub and the axle may be partially clamped with a quick release lever, which is operated just like a normal quick release. Systems in which the axle is only inserted and then fastened with a bolt also exist.

To adjust the installed quick release axle, read the axle manufacturer's operating instructions and follow them.



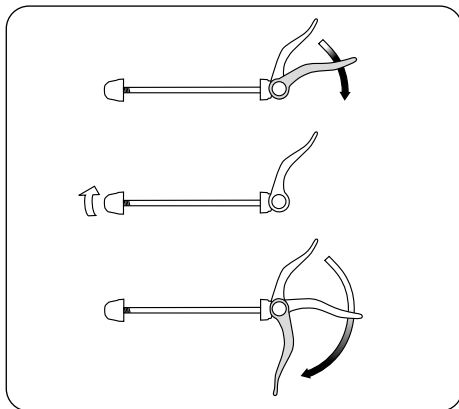

Loosening the adjusting nut

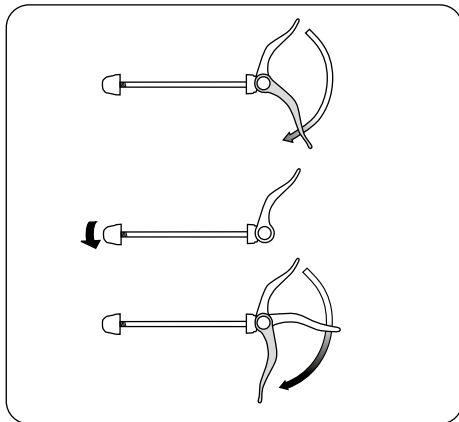

Tightening the adjustment nut



- All quick release levers and quick release axles must be firmly closed before you set off.
- Make sure all quick release levers and quick release axles are securely and properly fastened before every ride—even if the pedelec has only been left unattended for a short time.
- A closed quick release fastener must be folded in close to the frame, fork or seat post.
- When closed, the tip of the quick release lever must always rest tightly. The quick release lever should point to the rear. This way, it will not get bumped and open while you are riding your pedelec.

#### Handlebars with a quill stem

1. Remove the cover from the stem clamping screw.
2. Loosen the stem clamping screw with a hex key, turning anti-clockwise. Only loosen it a few turns.

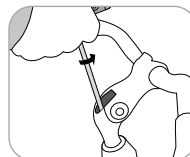
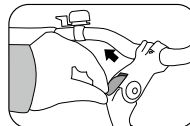

3. Align the stem so that the handlebars are at exactly a 90 degree angle, perpendicular to the front wheel.

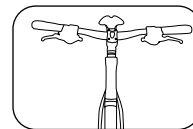

Information on the seat position and adjusting the stem and handlebars can be found in the original operating instructions on pages 19–21.

4. Use a suitable torque wrench to tighten the stem clamping screw clockwise.

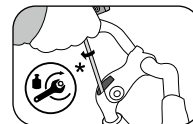

Threadless stems must be tightened with 22–24 Nm. If a different tightening torque is marked on the component, use that torque instead.

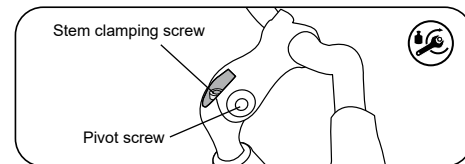

\* see page 40 in the original general instruction manual

- Bolt on the side (pivot for adjusting the angle): 14–16 Nm
- Bolt under the stem: 18–20 Nm

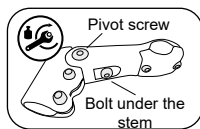

- Stem clamping screw beneath cover: 22–24 Nm

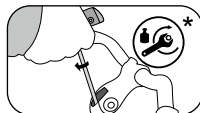

5. Replace the cover over the stem clamping screw.

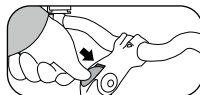

6. This is what your assembled handlebars and stem should look like when finished.

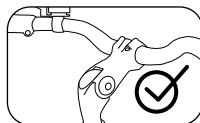

2. Align the stem so that the handlebars are at exactly a 90 degree angle, perpendicular to the front wheel.

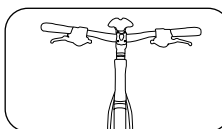

3. Now use a torque wrench to tighten the stem clamping screws clockwise.

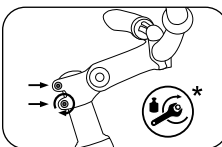

An A-head stem must be tightened to 14–16 Nm, and the pivot of an adjustable A-head stem to 14–16 Nm. If a different tightening torque is marked on the component, use that torque instead.



The stem may be pulled out of the fork tube only as far as the maximum marking. At least 65mm of the shaft must remain inside the fork tube.

## Handlebars with an A-head stem

1. Loosen the stem clamping screws of the stem with a 5 mm hex key, turning anticlockwise. Only loosen it a few turns.

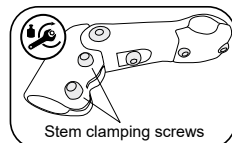
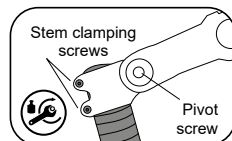
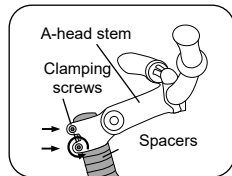

Stem clamping screw: 14–16 Nm Bolt  
Bolt on the side (pivot for adjustable-angle A-head stem): 14–16 Nm  
Bolt under the stem: 18–20 Nm

## Handlebars with a Stem Twist

With the Stem Twist, you can bring the handlebar into riding position in just a few steps.

1. Open the quick release lever ①.

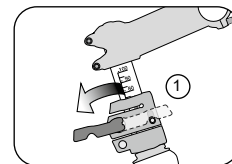

2. Turn the handlebars 90 degrees until the locking mechanism is visible and audibly clicks and the safety bolt ② on the stem is visible.

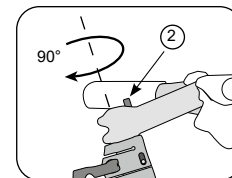

If the safety bolt ② does not move smoothly or does not automatically extend from the stem even though the locking mechanism is engaged, this can usually be fixed with a little spray lubricant. If it still does not lock smoothly and automatically, do not ride it. If this happens, please call our service hotline.

\* see page 40 in the original general instruction manual

3. Close the quick release lever completely to fasten the handlebars ③.

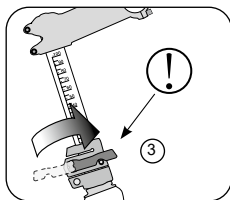

Before riding, check that the stem is secure and will not twist. To do this, stand in front of the pedelec and place the front wheel between your legs. Grab the ends of the handlebars and try to turn the handlebars against the front wheel. The handlebars must be hard to turn! If the handlebars and stem can be twisted, do not ride it! First tighten the stem's fork tube clamping screws properly. This must be done using a torque wrench. The correct tightening torque in this case is 6–8 Nm.

## Pedals

The pedals are marked differently to distinguish between right and left pedals. They are either marked with an "L" for left and an "R" for right ①, or with three engraved lines "|||" for left and no marking for right ②.

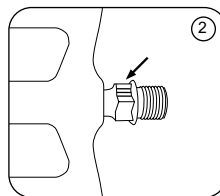
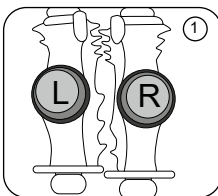

Screw the right pedal into the crank arm on the right side and the left pedal on the opposite side.

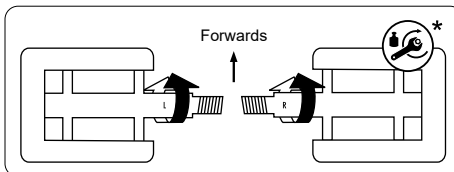

Apply assembly grease to both threads before assembling the pedals.



Note that the right pedal has a right-hand thread and therefore must be turned clockwise, while the left pedal must be turned anticlockwise. Use the included 15 mm open-end wrench or a special long pedal wrench. The appropriate tightening torque is 40 Nm.



If the pedals are mixed up or cross-threaded, the threads will be damaged. The pedals could break

off from the crank, which can lead to a crash and severe injuries.

## Folding pedals

Pull the securing device in the direction of the arrow (outwards). Then you can fold or unfold the pedal.

When unfolding, the safety device must engage audibly and perceptibly. Only then may you step on the pedal.

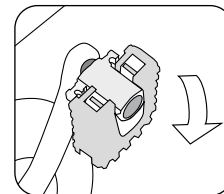
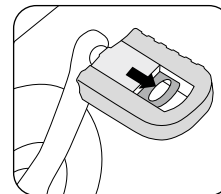

## Brake levers



When you squeeze the brake levers hard or all the way to the end of their leverage, the braking force can increase sharply! Please familiarize yourself with this unfamiliar braking effect. Read and follow the brake manufacturer's operating instructions. These can be found on the manufacturer's website. Contact our service hotline if you have any questions or are unsure of something.

\* see page 40 in the original general instruction manual



The brake levers should be set up so that your hands can safely and comfortably apply them as a straight extension of your arms.



Check the position of the brake levers before your first ride. Usually, the right brake lever operates the rear wheel brake and the left brake lever operates the front wheel brake. If you would like to swap the position of the brake levers on the handlebars, please contact a specialist retailer to do the work.

In order to allow people with smaller hands to safely apply the brakes, the levers can be set up to be closer to the handlebars using an adjusting screw (located in the lever). In some models it is possible to bring the brake levers closer to the handlebars, using special devices.

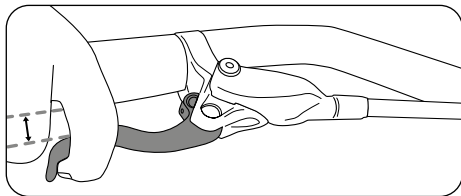

Set up the cable tension in such a way that the brake levers do not touch the handlebar grip, even when they are applied to their fullest extent!

## Adjusting the seat

Before you use your pedelec for the first time, the saddle position has to be adjusted to suit your body size. This will allow you to ride your bike safely.

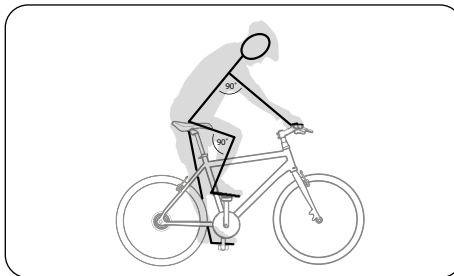

The height, horizontal orientation and inclination must be adjusted for the saddle and the height and orientation of the stem for the handlebars.

### Correct seat height

Adjust the saddle to the estimated correct height. Sit on the pedelec. Have someone help hold you in place or lean against a wall or railing. Move a pedal to its lowest position and place your heel on it. Your leg should now be straight. If you now place your foot in the correct riding position, your leg should be slightly bent. You are using the correct foot position for riding when your foot's widest point is above the pedal axle.



If your pedelec has full suspension, a piece of Bowden cable may be exposed at the bottom of the seat tube. This is the cable for the adjustable seat post. It should not be shortened or fixed. The free length of the cable is needed for height adjustment and maintenance of the seat post.

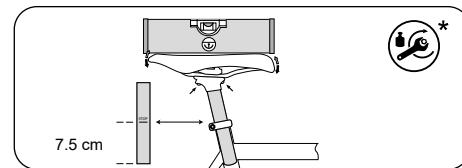

Never pull the seat post further out than the maximum mark on the tube frame! If there is no maximum mark, the seat post should always be at least 7.5 cm deep in the tube frame.



To correctly and safely adjust the saddle and seat position, refer to the information in the original operating instructions on pages 19–21. The required tightening torques can be found on the component or in the "Tightening torques" section in the original operating instructions.

\* see page 40 in the original general instruction manual



Children and people who feel insecure when riding should be able to touch the ground with their toes. Otherwise, when stopping they run the risk of falling and suffering serious injury.

### Saddle tilt

If you have adjusted the saddle height, the saddle inclination should be checked and adjusted as well. The surface of the saddle should always be level. You can perform this adjustment when the seat clamp bolts (saddle tilt) of the seat post have been undone.



Before you start riding, please test to see if your seat post and seat are secure. To do this, grasp the saddle at the front and back and attempt to turn it. It should not move.



For information concerning the installation and service of threaded and telescopic seat posts, read the manufacturer's service manual.

### Handle bar position / Stem



Only experts should work on your handlebars and stem.



You should always be able to safely reach and use grips and controls. Please ensure that all cables and lines are long enough to allow you to turn the handlebars in every possible way.



For detailed information about your stem, please read the operating instructions supplied by the manufacturer.

### Suspension

If your pedelec is equipped with suspension elements, they must be adjusted to suit the rider's weight and intended purpose. Such work requires specialist knowledge and experience and should only be performed with the help of a specialist/Fischer service technician.



Carefully read the enclosed manual concerning the suspension system to your pedelec.



Tighten all screws to the recommended torque to avoid screws falling out or breaking and parts falling off.



Perform the following test before the first ride: Lift your pedelec up slightly and drop it onto the ground from about 10 cm in the air. If you hear loud rattling or other unusual noises, check all bolted connections. If you hear rattling and unusual noises after checking, please contact our service hotline.

Now perform the check from the section "Before your first ride" in the original operating instructions.

## Instructions about electrics and electronics



Modern battery technology is high tech. It is very powerful. Using it requires particular care, knowledge and experience. Please read all the instructions in the original operating instructions on how to handle the battery. Be careful when handling the battery. It is heavy. Due to its high energy density, it is more dangerous if handled incorrectly.



Don't let children who are unattended ride the pedelec without first thoroughly instructing them on how to use it. Explain to children the dangers of using electrical devices.



Keep in mind that on a pedelec you are travelling much faster than you would on a bicycle without an electric drive. Other road users may misjudge this. Only use your pedelec for the intended use (page 14). If you are unsure about the intended use of the pedelec, please contact our service hotline.



Your pedelec has a "pushing aid" function, whereby it moves at up to 6 km/h without the need to pedal yourself. The pushing aid function works to assist you if you, for example, have to climb a steep ramp from an underground car park or underpass. Do not use it to ride the bike.



Note that if the road surface or ground are slippery (due to rain, snow, sand, etc.), there is a risk that the drive wheel of your pedelec may skid and slide.

### Charging process



In some models you can charge the battery while it is mounted in the Pedelec. Please read the system manual in this regard.



Before using your pedelec, you may need to configure the display panel. To do this, please read the "Displays and settings" section on page 17 of the system manual.

### Charger

- Only use the charger that came with your bike or one from the same manufacturer.
- Only use the charging device in dry conditions and do not cover it when in use, to avoid the danger of short-circuits or fire.
- Read the instructions on the charger before you start charging the battery.

### Maintenance and care



Always remove the battery before doing any kind of work on the electrical system to your pedelec.

### Before the first ride



Practice operating and riding your pedelec in a quiet and safe place before you take to public roads!

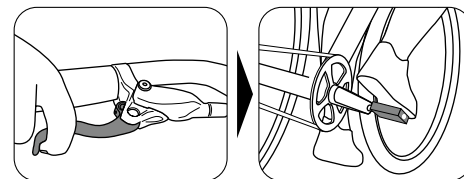



Always squeeze the brakes of your pedelec before placing a foot on the pedal. The electric engine starts working as soon as you begin to pedal. This boost is surprising to begin with, and can lead to falls or cause dangerous traffic accidents and injury to occur.

Ensure that the pedelec is ready for use and adjusted to fit your body.

That means:

- The seat is comfortably and securely positioned and secured (see page 19/21)
- The handlebars are comfortably and securely positioned and secured (see page 21)
- Mounting and adjusting the brakes (see page 22)
- Making sure the brake handles are easily accessible (see page 21)
- Familiarising yourself with the assignment of brake handles to the front (left brake handle) and rear wheels (right brake handle).
- Fastening the wheels securely onto the frame and the fork
- Checking that the tyre pressure is correct

It is also necessary for you to check the following components of your pedelec:

- The battery is secure
- Ensure the battery is sufficiently charged for the planned trip



On some models, the battery must be actively locked with the key when it is inserted.

Familiarise yourself with the functions of the operating element.

Press the “on/off” button on your external control unit to switch on the electrical system.

To turn it off, push and hold down the same button until the system turns off.

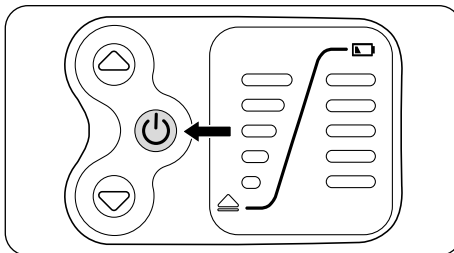

Example illustration of a control unit

You change the motor assistance via the arrow or +/- button.

⊕ or the “+” button: Pressing it briefly increases motor assistance. The motor then works more strongly.

⊖ or the “-” button: Pressing it briefly reduces motor assistance. The motor then works less strongly.

When riding in the dark, you must turn on the lights. Switch the light on or off using the ☞ button.

If your control unit does not have an “☞” button, pressing and holding the “⊖” or “+” button will turn the light on and off.

If the pedelec is equipped with a Bafang control unit, the rear light is always on when the electrical system is on.



Modern braking systems might be more powerful or have a different functionality than those that you are used to. Practice operating the brakes in a safe area without traffic before you start a journey. Also remember that the effectiveness of brakes can be different to what you are used to in wet conditions or on slippery surfaces. Adapt the way you cycle for slippery surfaces with possibly longer braking distances.



If rubber or plastic pedal covers have been put on your pedelec, familiarise yourself with their grip. When wet, rubber and plastic pedals are very slippery.

Make sure the wheels are securely fastened in the frame and fork. Check that the quick releases, quick release axles and all important nuts and bolts are secure.

Lift your pedelec up slightly and drop it onto the ground from about 10 cm in the air. If you hear rattling or other unusual noises, please contact our service hotline.

Check the air pressure in the tyres. You will find information as to the correct tyre pressure on the sides of the tyres. Please adhere to the required minimum and maximum pressure!

You can ride your bicycle with different tire pressures.

Low tire pressure allows for more suspension: Riding comfort increases.

High tire pressure reduces rolling resistance on slippery surfaces: You need less force to pedal. Take the following into account when adjusting the tire pressure:

- The higher the rider's weight, the higher the tire pressure should be. The lower the rider's weight, the lower the tire pressure can be.
- Inflate the tires with higher tire pressure if the ground is slippery. On uneven terrain, you will ride more comfortably with slightly lower tire pressure.

As a general rule of thumb when you are out on a ride, you can check the tyre pressure by doing the following: If you place your thumb on a pumped-up tyre, you should not be able to significantly change its shape by applying pressure.

In addition, check whether there is an indication of maximum tyre pressure stated on the rim. If so, this specified pressure must not be exceeded.

## Mechanical components

### Back pedal brakes

If your pedelec is equipped with back pedal brakes, brake by pushing the pedals backwards instead of forwards. This means that your pedelec will not freewheel and you are unable to rotate the pedals backwards freely as you otherwise can.



The safest way to brake using back pedal brakes is when the pedals are at the same height parallel to the ground. If one pedal is at the top and one at the bottom, it is difficult to produce enough force to brake effectively.



The effectiveness of back pedal brakes can deteriorate substantially on long inclines! This type of braking system can become very hot from continuous braking. You should also use the front brake to slow down on long inclines. Wait until the back pedal brake has cooled down and do not touch the brake drum.

### Chain



To ensure that the chain and gears work safely, the chain has to have a certain level of tension. Derailleur gear systems tense the chain automatically. In the case of hub gears, chains which are too loose must be tightened. It might otherwise jump off the gears and lead to a fall.

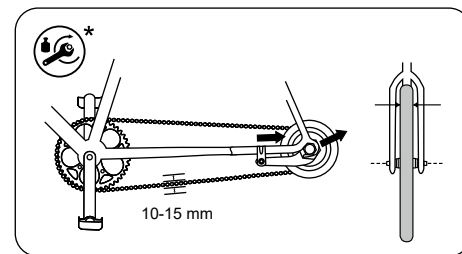

### Brakes



You can find information about the brakes on your pedelec and how to use them in the original operating manual, the manufacturer's manual and on their websites.

\* see page 40 in the original general instruction manual



## Hydraulic Disc Brakes



The brake lever may not be applied if the pedelec is on its side or upside down. Otherwise air bubbles can enter the hydraulic system which could cause the brakes to fail. After transporting the pedelec, check if the pressure point of the brakes seems softer than before.

## Gear change system



Easy-to-understand video instructions for adjusting derailleurs and hub gears can be found on our website at: <https://service.fischer-bike.com/downloads>

Your pedelec's gears have been carefully assembled and adjusted by the manufacturer. In rare cases, a gear may become misaligned while in transport. You can tell that this is the case if the individual gears do not easily click into place, the chain slips or a permanent clicking or slight rattling occurs while riding it. If this happens, turn the adjusting screw on the gearshift handle a quarter turn in either direction and try again to see whether the gear clicks in more easily or whether there is less noise when riding it. If it has become easier to shift gears, repeat the

adjustment until the gears are working properly and quietly. If it becomes worse and the noises become louder, turn the adjusting screw in the other direction.



You can get more information about the brakes on your pedelec in the operating manual provided by your manufacturer or on the manufacturer's website.

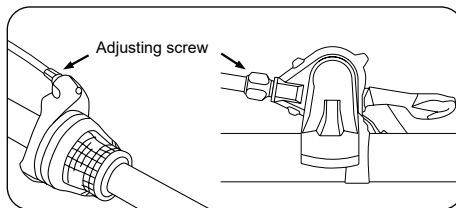

## Loose / mounted accessories



You always have to fit the enclosed accessories in line with the guidelines and instructions.



You have to ensure that screwed connections are secured with the correct torque.



You can find more information about the parts on your pedelec on the manufacturer's website.

## Luggage rack



Luggage load changes the behaviour of your pedelec. It extends the braking distance, among other things. This may lead to severe accidents. Please adjust your riding style to this, i.e. brake earlier and anticipate more sluggish steering. Only transport baggage on racks intended for this purpose! Never attach a baggage rack to the seat post! It is not designed for this purpose. Overloading of the seat post by a luggage rack can break the seat post and lead to serious accidents!

# EC- Declaration of Conformity



in accordance to Machinery Directive 2006/42/EC & radio equipment Directive 2014/53/EC

Manufacturer/responsible person MTS MarkenTechnikService GmbH & Co. KG /Herr Daniel Lück

Product EPAC/Pedelec (electric power assistants cycle)

Brand Fischer, die Fahrradmarke

Models Cita U100 43, Cita U100 50, Cita 6.8i 43, Cita 6.8i 50,  
Viator 4.2i 43, Viator 4.2i 45, Viator 4.2i 50 W, Viator 4.2i 50 T, Trekking TR110 M Trapez 50  
Viator 6.8i 43, Viator 6.8i 45, Viator 6.8i 50 W, Viator 6.8i 50 T, Viator 6.8i 55,  
Montis 8.0i 43, Montis 8.0i 46, Montis 8.0i 49, Montis 10.0i 43, Montis 10.0i 46,  
Terra 6.8i 43, Terra 6.8i 45, Terra 6.8i 50 W, Terra 6.8i 50 T, Terra 6.8i 55

Used Standards DIN EN 15194:2017-12, DIN EN 17404:2022-07, DIN EN ISO 4210-2:2015-12

The object of the declaration described above is in conformity with Directive 2011/65/EU of the European Parliament and of the Council of 8 June 2011 on the restriction of the use of certain hazardous substances in electrical and electronic equipment.

- ☒ Machinery directive 2006/42/EG    ☒ Radio equipment directive 2014/53/EU  
☒ low voltage directive 2014/35/EU (*for charger*)

Address MTS Group Inter-Union Technohandel GmbH  
Carl-Benz-Str. 2, 76761 Rülzheim

Phone +49 (0)7272/9801-100  
Fax +49 (0)7272/9801-123  
mts-gruppe.com

Rülzheim, 7<sup>th</sup> July 2025

Daniel Lück  
Managing Director

Christian Rüffel  
Head of Fischer Bike

Place and date of issue

Name and signature

Authorised representative for technical documentation: Thomas Stephan MTS Group, Carl-Benz-Str. 2, 76761 Rülzheim

# EC- Declaration of Conformity



in accordance to Machinery Directive 2006/42/EC & radio equipment Directive 2014/53/EC

Manufacturer/responsible person MTS MarkenTechnikService GmbH & Co. KG / Herr Daniel Lück

Product EPAC / Pedelec (electric power assistants cycle)

Brand Fischer, die Fahrradmarke

Models Cita 2403 43, Cita 2403 50, Cita 2404 43,  
Viator 2.1 45, Viator 2.1 50, Viator 2.1 55,  
Terra 2.2 45, Terra 2.2 50, Terra 2.2 55  
Montis 2.2 43, Montis 2.2 49

Used Standards DIN EN 15194:2017-12, DIN EN 17404:2022-07, DIN EN ISO 4210-2:2015-12

The object of the declaration described above is in conformity with Directive 2011/65/EU of the European Parliament and of the Council of 8 June 2011 on the restriction of the use of certain hazardous substances in electrical and electronic equipment.

- ☒ Machinery directive 2006/42/EG    ☒ Radio equipment directive 2014/53/EU  
☒ low voltage directive 2014/35/EU (*for charger*)

Address MTS Group Inter-Union Technohandel GmbH  
Carl-Benz-Str. 2, 76761 Rülzheim

Phone +49 (0)7272/9801-100  
Fax +49 (0)7272/9801-123  
mts-gruppe.com

Rülzheim, 7<sup>th</sup> July 2025

Daniel Lück  
Managing Director

Christian Rüffel  
Head of Fischer Bike

Place and date of issue

Name and signature

Authorised representative for technical documentation: Thomas Stephan MTS Group, Carl-Benz-Str. 2, 76761 Rülzheim

## After Sales Service

### Service in Germany and Austria:

Für Fragen zu Ihrem Pedelec nutzen Sie bitte die Fischer Community unter <https://community.fischer-fahrrad.de/customers/s>, schreiben uns eine E-Mail an **support@fischer-fahrrad-kundendienst.de** oder Sie wenden sich an unsere Service Hotline in Deutschland **+49 721 97902560** oder unsere Service Hotline in Österreich **+43 1 9073366**.

### Service in the Netherlands and Belgium:

Je hebt een probleem ontdekt met je e-bike? FSN+, als partner van FISCHER, staat hier aan uw zijde!

Registreer uw fiets/e-bike op de website van FSN+ en ervaar zorgeloze fietstochten met het volledige servicepakket! U kunt ook telefonisch contact met ons opnemen op het volgende telefoonnummer: **+800-32797834**

**Fischer-Service-NL@mts-gruppe.com**

Vous avez rencontré un problème avec votre VAE? FSN+, en tant que partenaire de FISCHER, est à vos côtés !

Enregistrez votre VAE sur le site web de FSN+ et faites l'expérience de tours à vélo sans soucis grâce au pack de services complet ! Vous pouvez également nous contacter par téléphone au numéro suivant : **+800-32797834**

**Fischer-Service-BE@mts-gruppe.com**

### All other countries:

**EN** Dear customer, if you have any questions or problems with your FISCHER e-bike, please first contact the company/store where you purchased the FISCHER e-bike directly. There you will get an answer.

**FR** Cher client, si vous avez des questions ou des problèmes avec votre VAE FISCHER, veuillez d'abord contacter directement la société/succursale où vous avez acheté le VAE FISCHER. Vous y obtiendrez une réponse. Ou écrivez à l'adresse électronique suivante **Fischer-Service-F@mts-gruppe.com**

**ES** Estimado cliente, si tiene alguna pregunta o problema con su FISCHER E-Bike, por favor contacte primero con la compañía/sucursal donde compró la FISCHER E-Bike directamente, allí obtendrá una respuesta. También puede escribir a la siguiente dirección de correo electrónico: **Fischer-Service-E@mts-gruppe.com**

**CZ** Vážený zákazník, pokud máte jakékoli dotazy nebo problémy s elektrokolem FISCHER, obraťte se nejprve přímo na společnost/obchod, v němž jste elektrokolo FISCHER zakoupili. Nebo se obraťte na: **servis@kolofix.cz**

**+800 01 01 01.**

**HR** Servis vám odgovori.

Poštovana korisnice, poštovani korisnici, ako imate pitanja ili problema s vašim FISCHER električnim biciklom, molimo vas da se prvo izravno obratite tvrtki/dućanu od kojeg ste kupili vaš FISCHER električni bicikl. Alternativno, možete nas kontaktirati na **+800-32797834**.

**PL** Drogi Kliencie, w przypadku pytań lub problemów z rowerem elektrycznym FISCHER, najpierw skontaktuj się bezpośrednio z firmą/sklepem, w którym dokonałeś zakupu roweru elektrycznego FISCHER.

Alternatywnie, skontaktuj się z nami drogą mailową: **serwis@fischer-ebike.pl**, **+48 22 738 64 60**

Tam uzyskasz pomoc.

**PT** Caro cliente, se tiver quaisquer perguntas ou problemas com a sua e-bike FISCHER, por favor contacte primeiro a empresa/loja onde adquiriu directamente a e-bike FISCHER. Ai obterá uma resposta.

**FI** Hyvä asiakas, jos sinulla on kysymyksiä tai ongelmia FISCHER-sähköpyöräsi kanssa, ota ensin yhteyttä yritykseen/myymälään, josta ostit FISCHER-e-pyörän suoraan. Siellä saat vatsauksen.

**SE** Kära kund, om du har några frågor eller problem med din FISCHER e-cykel, vänligen kontakta först företaget / butiken där du köpte FISCHER e-cykel direkt. Där får du ett svar.

**DK** Kære kunde, hvis du har spørgsmål eller problemer med din FISCHER elcykel, bedes du først kontakte det firma/den butik, hvor du har købt din FISCHER elcykel direkte. Alternativt kan du også kontakte os på **+800-32797834**.